

# Strength in Every Pull





**QUALITY & PRODUCTION**



# MANUAL LEVER HOIST

## EPL MANUAL LEVER HOIST

### Standard: EN 13157

- › The Europull series manual lever hoist can be widely used for equipment installation, lifting and tightening goods, dragging loads in factories, mines, construction sites, power plants, boat manufacturing etc.
- › It is an ideal device especially in narrow space, open air and over-head places for pulling and stretching at angle.

### Features:

- › Compact, light yet durable.
- › Double-pawl brake system designed for safety and reliability.
- › Heat treatment steel plates, gears and shafts for enhanced strength.
- › Forged upper, lower hooks with forged steel safety latches, high tensile alloy steel chain.
- › The lifting chain can be freely pulled and operated by special separating block design.
- › Weston style automatic load brake with double pawls load reduction.
- › 360° rotating handle eases of using in confined space.
- › As for the N position of the shift block, the position of the bottom hook can be freely adjusted according to the need when unloaded.
- › Safety factor: 4 to 1
- › Fatigue tested at 1.5 times of working load limit to 2000 cycles.



## Technical details

Model		EPL-0.75T	EPL-1T	EPL-1.5T	EPL-2T	EPL-3T	EPL-6T	EPL-9T
Capacity load	(t)	0.75	1	1.5	2	3	6	9
Load chain Number of falls		1	1	1	1	1	2	3
Load chain specifications	(mm)	6.3x19	6.3x19	7.1x21	7.1x21	9x27	9x27	9x27
Effort required to lift max load	(N)	260	210	450	460	430	490	490
Test Load	(kg)	1130	1500	2250	3000	4500	9000	13500
Standard lift	(m)	1.5	1.5	1.5	1.5	1.5	1.5	1.5
Net weight	(kg)	6.90	7.10	9.70	9.88	16.30	26.70	38.50
Gross weight	(kg)	7.90	8.10	10.70	10.88	17.30	28.70	40.50
Packing size	(cm)	38*14*19	38*14*19	53*16*22	53*16*22	55*18*23	56*20*24	58*37*22
Add 1m weight	(kg)	0.86	0.86	1.10	1.10	1.76	3.52	5.28
Dimensions(mm)	A	148	148	163	163	191	191	191
	B	128	128	148	148	181	244	314
	C	37	45	47	47	62	78	-
	D	256	256	368	368	368	368	368
	g	28	33	33.5	33.5	43.5	51	64
	H	295	310	335	335	405	550	680

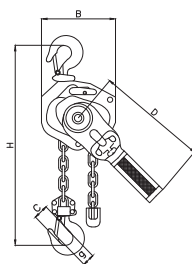

EPL-0.75T & 1T

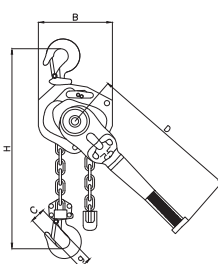

EPL-1.5T - 3T

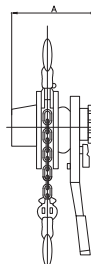

EPL- 6T

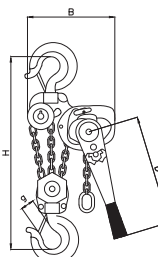
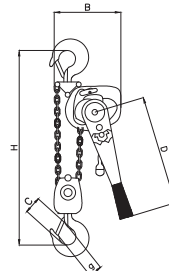

EPL- 9T

# MANUAL CHAIN HOIST

## EPC MANUAL CHAIN HOIST

**Standard: EN 13157**

- » The Europull Manual Chain hoist is used in construction, marine, oilfield projects.
- » Chain hoist capacity range from 0.5 ton to 100 ton.
- » Multi-support structure, more reasonable force, flexible operation and low failure rate of the transmission system.
- » With double pawls, increase the safety factor in 2 times.
- » All nuts in anti-slip nuts.
- » Smooth rotation, high efficiency, light hand pull.
- » The hand cover uses special crimping process, keep the hand chain not tilting and not snapping.
- » Fitted with high strength grade 80 alloy steel load chain with galvanized finish for corrosion resistance (comply with EN 818-7, safety factor 4).

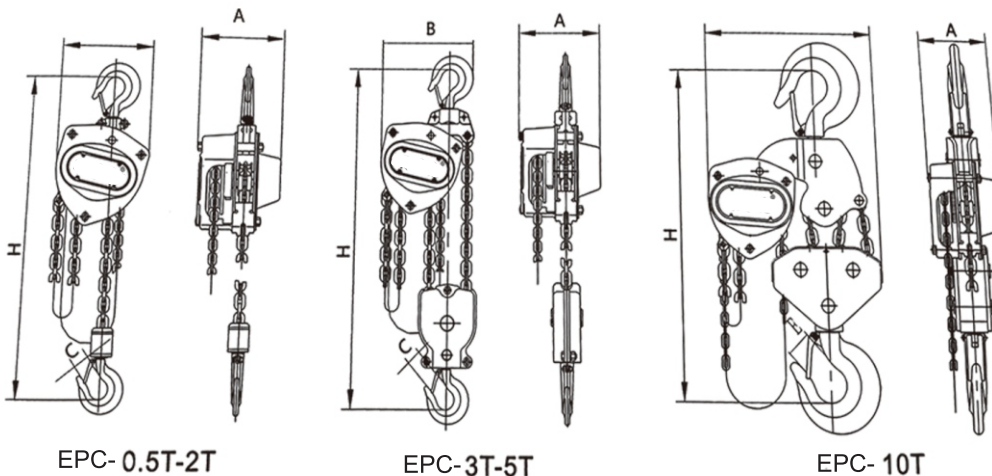

### Technical details

Model	EPC-0.5T	EPC-1T	EPC-2T	EPC-3S	EPC-3D	EPC-5T	EPC-7.5T	EPC-10T	EPC-15T	EPC-20T	EPC-30T	EPC-50T	EPC-100T
Capacity	(t) 0.5	1	2	3	3	5	7.5	10	15	20	30	50	100
Standard lift	(m) 3	3	3	3	3	3	3	3	3	3	3	3	3
Running Test	(t) 0.75	1.5	3	4.5	4.5	7.5	10	12.5	15	20	30	50	100
Effort required to lift max load	(N) 240	250	335	363	370	360	410	380	435	435*2	435*2	435*2	435*4
Load chain number of falls	1	1	1	1	2	2	3	4	6	8	12	22	20*2
Load chain Diameter	(mm) 5	6	8	10	8	10	10	10	10	10	10	10	10
Hand chain size	(mm) 5*25	5*25	5*25	5*25	5*25	5*25	5*25	5*25	5*25	5*25	5*25	5*25	5*25
Net Weight	(kg) 11.00	12.50	19.50	29.00	24.00	41.30	79.00	78.50	120.00	193.00	220.00	1092.00	1500.00
Packing size (cm)	(cm) 24*19*18	28*21*21	34*26*20	34*26*20	34.5*24*16	41*32*24	48*42*18.5	48*42*18.5	69*56*20	78*68*20	85*67*30	110*100*130	220*320*800
Dimension (mm)	A	132	151	175	176	151	189	188	189	190	192	330	745
	B	148	172	210	230	208	280	398	463	580	630	670	1140
	C	28	32	36	46	46	46	57	57	75	82	106	170
	H	345	376	470	565	475	688	720	765	870	890	1000	2680

# SL-ST STAINLESS STEEL CHAIN HOIST ★

## OFFSHORE AND SUBSEA PRODUCTS

- » 1. The main components are made of all stainless steel, which has strong anti-fouling, anti-corrosion and anti-wear properties.
- » 2. The surface of the product is smooth and compact, not easy to be dusty and has good self-cleaning properties.
- » 3. The hoist is easy to maintain, as it gets scratches or rust in daily use.
- » 4. It is widely used in food, chemical, biological, marine and other places with corrosive factors and high cleanliness requirements.

Note: It is the responsibility of the user to tell in which corrosive environment the product is used.

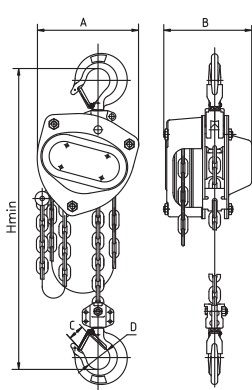

0.5t ~ 1t

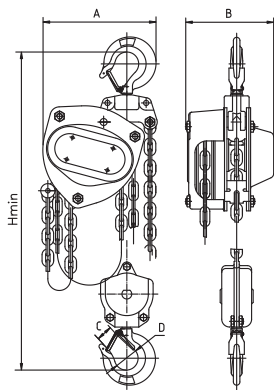

2t ~ 3t

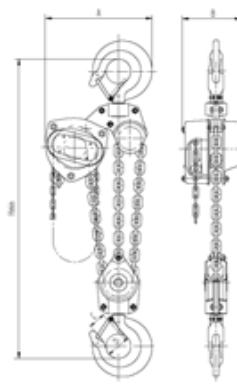

5t

## Technical details

Model		SL-0.5	SL-1	SL-2	SL-3	SL-5
Capacity	<i>t</i>	0.5	1	2	3	5
Lifting height	<i>m</i>	2.5	2.5	2.5	3	3
Test load	<i>KN</i>	6.25	12.5	25	37.5	62.5
Pull on lever to lift full load	<i>N</i>	290	305	335	345	300
No. of load chain falls		1	1	2	2	3
Diameter of load chain	<i>mm</i>	6x18	7x21	7x21	9x27	10x30
Dimensions <i>mm</i>	<i>A</i>	142	172	192	230	365
	<i>B</i>	131.5	151	151	173	189
	<i>C</i>	26	26	34	39	41
	<i>D</i>	40	40	50	55	65
	<i>Hmin</i>	360	376	425	565	710
Net weight	<i>kg</i>	11	13.6	20.5	32.2	60
Extra wt. per m	<i>kg</i>	1.65	1.97	3.1	4.37	7.3

# SS-F3 MARINE ANTI-CORROSION CHAIN HOIST ★

## OFFSHORE AND SUBSEA PRODUCTS

It is ideal for safe use in marine environments and where the sea water salinity is high, with less care and maintenance cost.

- » 1. The product has passed ISO9001, ISO14001, CE/GS, LR, CCS and other related certifications.
- » 2. Applicable to marine high salinity environment.
- » 3. The product uses special anti-corrosion treatment, in line with ISO12944 standard; the highest anti-corrosion grade can reach C5-M.
- » 4. Stainless steel lifting chain, special marine storage chain bag, overload limiter are optional

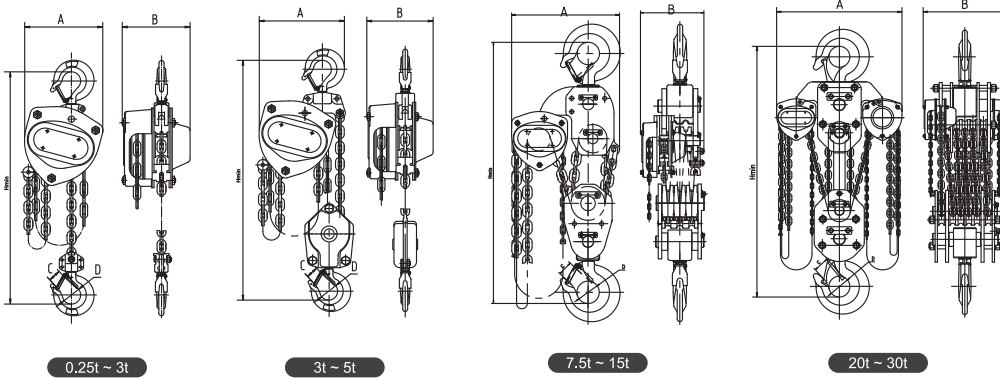

## Technical details

Model		F3-0.5	F3-1	F3-1.5	F3-2	F3-3	F3-3	F3-5	F3-10	F3-15	F3-20	F3-30
Capacity	<i>t</i>	0.5	1	1.5	2	3	3	5	10	15	20	30
Lifting height	<i>m</i>	2.5	2.5	2.5	2.5	3	3	3	3	3	3	3
Test load	<i>KN</i>	6.3	12.5	18.8	25	37.5	37.5	62.5	125	187.5	250	375
Pull on lever to lift full load	<i>N</i>	240	250	265	335	372	280	380	385	385	390x2	240
No. of load chain falls		1	1	1	1	1	2	2	4	6	8	12
Diameter of load chain	<i>mm</i>	5x15	6x18	7x21	8x24	10x30	7x21	10x30	10x30	10x30	10x30	10x30
Dimensions <i>mm</i>	<i>A</i>	148	172	196	210	255	280	280	385	405	640	705
	<i>B</i>	132	151	173	175	205	230	189	189	242	226	454
	<i>C</i>	23	26	29.5	34	39	39	41	50	80	80	80
	<i>D</i>	35	40	45	50	55	55	65	85	110	110	110
	<i>Hmin</i>	345	376	442	470	580	580	690	780	920	980	1280
Net weight	<i>kg</i>	8.6	11	15	18	30.5	24.4	41	71.7	116	164	350
Extra wt. per m	<i>mm</i>	1.41	1.67	1.97	2.27	2.95	3.10	5.27	9.67	14.07	19.34	28.14

# EX-F3 SPARK PROOF CHAIN HOIST ★

**ATEX** EN13157

- » 1. The product complies with the EU's explosion-proof standard ATEX2014/34/EU and the Machinery Directive 2006/42/EC. The design is in accordance with EN13157 standard, it meets all pertinent world standards.
  - » 2. The company has passed ISO9001, ISO14001, CE/GS, ATEX, LR, CCS and other related certifications.
  - » 3. The product explosion-proof level can reach: Ex II 2 GD c IIC T4 IIIC T135 °C. Suitable for: potential explosive atmospheres or dusty environments. Area: Zone 1 & 2 (gas), Zone 21 & 22 (dust).
  - » 4. The whole product is equipped with anti-spark coating, and the brake device is completely protected to prevent foreign matter from entering.
  - 5. Stainless steel lifting chain, special marine storage chain bag, overload limiter are optional.
- Note: It is the responsibility of the user to determine the type of explosion protection area.

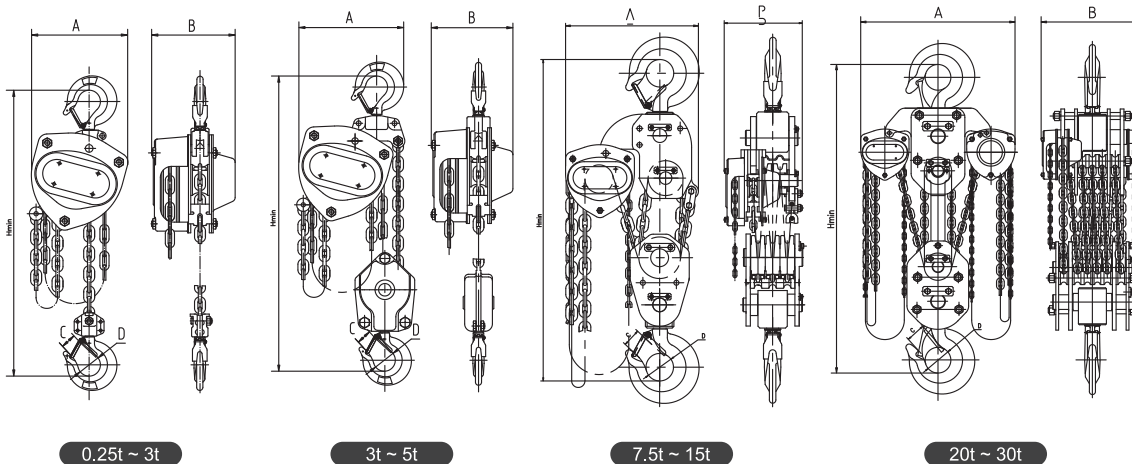

## Technical details

Model		F3-0.5	F3-1	F3-1.5	F3-2	F3-3	F3-3	F3-5	F3-10	F3-15	F3-20	F3-30
Capacity	<i>t</i>	0.5	1	1.5	2	3	3	5	10	15	20	30
Lifting height	<i>m</i>	2.5	2.5	2.5	2.5	3	3	3	3	3	3	3
Test load	<i>KN</i>	6.3	12.5	18.8	25	37.5	37.5	62.5	125	187.5	250	375
Pull on lever to lift full load	<i>N</i>	240	250	265	335	372	280	380	385	385	390x2	240
No. of load chain falls		1	1	1	1	1	2	2	4	6	8	12
Diameter of load chain	<i>mm</i>	5x15	6x18	7x21	8x24	10x30	7x21	10x30	10x30	10x30	10x30	10x30
Dimensions <i>mm</i>	<i>A</i>	148	172	196	210	255	230	280	385	405	640	705
	<i>B</i>	132	151	173	175	205	173	189	189	242	226	454
	<i>C</i>	23	26	29.5	34	39	39	46	50	80	80	80
	<i>D</i>	35	40	45	50	55	55	65	85	110	110	110
	<i>Hmin</i>	345	376	442	470	580	580	690	780	920	980	1280
Net weight	<i>kg</i>	8.6	11	15	18	30.5	24.4	41	71.7	116	164	350
Extra wt. per m	<i>mm</i>	1.41	1.67	1.97	2.27	2.95	3.10	5.27	9.67	14.07	19.34	28.14

# EX-L3 SPARK PROOF LEVER HOIST

★ **ATEX** EN13157



- 1. The product complies with the EU's explosion-proof standard ATEX2014/34/EU and the Machinery Directive 2006/42/EC.  
The design is in accordance with EN13157 standard, it meets all pertinent world standards.
- 2. The company has passed ISO9001, ISO14001, CE/GS, ATEX, LR, CCS and other related certifications.
- 3. The product explosion-proof level can reach:  
Ex II 2 GD c IIC T4 IIIC T135 °C.  
Suitable for: potential explosive atmospheres or dusty environments.  
Area: Zone 1 & 2 (gas) Zone 21 & 22 (dust)
- 4. The whole product is equipped with anti-spark coating, and the brake device is completely protected to prevent foreign matter from entering
- 5. Stainless steel lifting chain, special marine storage chain bag overload limiter are optional

Note: It is the responsibility of the user to determine the type of explosion protection area.

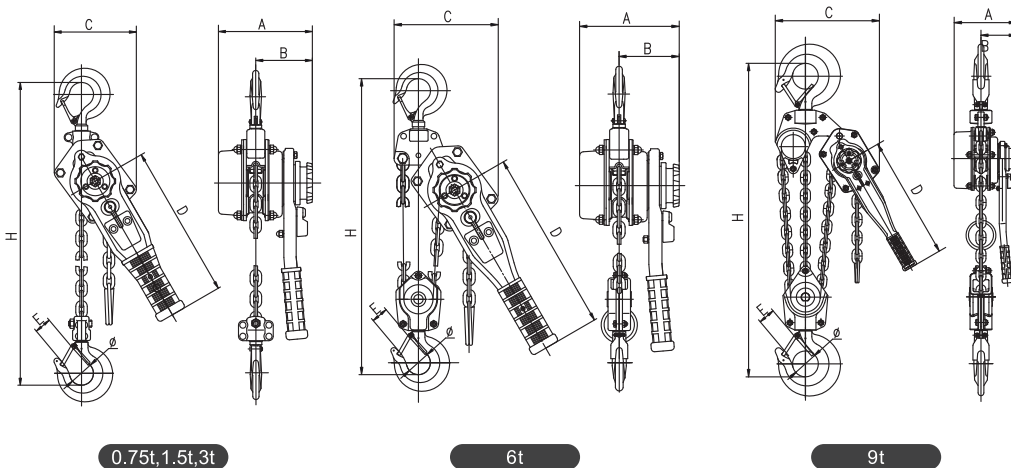

## Technical details

Model		L3-0.5	L3-0.75	L3-1.5	L3-3	L3-6	L3-9
Capacity	t	0.5	0.75	1.5	3	6	9
Lifting height	m	1.5	1.5	1.5	1.5	1.5	1.5
Test load	KN	6.3	9.38	18.8	37.5	75	112.5
Pull on lever to lift full load	N	256	250	373	395	398	400
No. of load chain falls		1	1	1	1	2	3
Diameter of load chain	mm	5x15	6x18	7x21	10x30	10x30	10x30
Dimensions mm	A	143	157	178	206	206	206
	B	90.5	94	104	118	118	118
	C	118	140	145	199	230	342
	∅	31.5	37.5	42.5	50	65	85
	E	22	26	29	39	46	55
	Hmin	330	365	400	520	595	800
Net weight	kg	5.5	7.5	9.6	20	30	51
Extra wt.per m	mm	0.55	0.8	1.1	2.15	4.3	6.45

# ELECTRIC CHAIN HOIST

## EPSSDHL-ADVANCE FEATURES OF ELECTRIC CHAIN HOIST



### Electric Trolley

The width of flange range is adjustable. Motor is included with disc type brakes. Side guide rollers is to protect the trolley motion smooth and minimize the wear of wheel and beam.



### Heavy Duty Hoist Motor

Aluminum alloy shell is lightweight but strong. The cooling fan is specially designed to ensure quick heat dissipation with rate up to 40% in continuous service.



### Upper and Lower Limit Switch

When over-lifting or over-lowering happens, The limit switch will cut off the motor circuit and prevent it from damage of hoist structure and load chain.

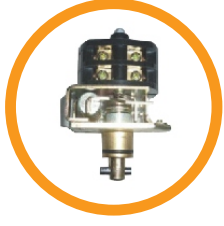

### Safe Brake System

Electric brake is designed for easy access with simple adjustment. It allows instant brake as soon as the electric power cut off. Thus the braking safety while loading is guaranteed.



### Load Sheave / Reduced Vibration

Increasing the number of Load sheave pockets helps to relieve vibrations produced by revolving polygonal sheave on hoist's body and load chain.

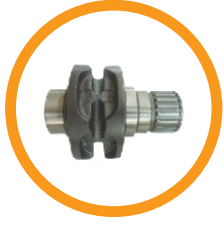

### Inverse Phase Sequence Protecting Device

It's a special electrical installation for controlling the circuit in case of wiring error in the power supply.



### Push Button Control

Compact design to enable one-handed operation. Rated with IP65 Protection. Emergency stop button is included. Push button cable has strain relief to prevent from cable damage.



### Chain Container

Canvas chain bag is a standard fittings. Operation fabricated steel bags are available for long lift applications.



### Hooks

The Load hook is forged carbon steel hook with a heavy-duty latch. Trust bearing hook allows 360° rotation to prevent twisting of load chain.



### Load Chain

G80 Ultra heat-treatable alloy steel chain, has a high resistance to protect from corrosion.







## ELECTRIC CHAIN HOIST

Europull Hebentechnik UK Ltd is a leading supplier of rigging hardware and material handling equipment. The Europull brand name is now synonymous with high quality products backed up with on time service.

In this catalog you will find details of our products that are used and trusted by people all over the world in the Marine, Offshore, Construction and Oilfield industries, among others.

All our products are manufactured to the relevant international standards, tested and certified. This means that when you use a genuine Europull product, you are sure that it is one of the best.

Standard Specification:			
Rated Capacity		0.5T to 50T	
Operation Method		Operating push button	
Lifting Modes		Single speed and dual speed	
Electrical Source		3Phase, 380v & 415v 50/60Hz	
Control Voltage		24V and 36V	
Working Group		M5	
Insulation Class of Motor		Class F	
Protection		IP54 for Hoist Body, IP65 for push button. IP55 & IP65 for whole hoist & trolley can be made on request	
Power Feeding System		Cable feeding	
		Suspension-type, with manual driven trolley or chain driven trolley With 6m cable or wireless remote	
		With motorized trolley	Cable and catch are not included with standard shipment.
Standard Push button	2points	 (For single speed)	
		 (For dual speed)	
	4points	For single speed	
For dual speed			
Max.No.of starts per hour		150 starts/h	
Suspension Type		Hook, Manual Trolley, Electric Trolley	
Working Temperature		-20 to 45°C (-4 to 113°F)	
Working Humidity		85%RH or less	

### Applicable EC Directives

EC Machinery Directive (2006/42/EC)

### Applied harmonized engineer standards:

EN ISO 12100 :2010 General principles for design- Risk assessment and risk reduction

EN 14492-2:2006+ A1:2009-Cranes- Safety

EN 818-7:2002 + A1:2008 Short link chain for lifting purposes – Safety-Part 7: Fine tolerance hoist chain, Grade T (Types T, DAT and DT)

EN 349:1993+A1:2008 Safety of machinery- Minimum gaps to avoid crushing of parts of the human body.

### Quality Assurance

EN ISO 9001:2015 Quality management systems

# ELECTRIC CHAIN HOIST

## EPSSDHL - Electric chain hoist & Load limiter

### Technical Parameters

Capacity (ton)	Hoist lifting(Up&Down)				Weight (kg)
	Lifting speed (m/min)	Motor Power (kw)	Dia of Chain (mm)	No. Of chain falls	
0.5	7.2	0.8	6.3	1	50
1	6.6	1.5	7.1	1	67
2	6.6	3.0	10.0	1	120
3	4.4	3.0	10.0	2	137
5	2.7	3.0	11.2	2	148
7.5	1.8	3.0	11.2	3	203
10	2.7	3.0*2	11.2	4	344
15	1.8	3.0*2	11.2	6	412
20	1.4	3.0*2	11.2	8	522
25	1.1	3.0*2	11.2	10	540
30	0.9			12	820
50	0.55	3.0*2	11.2	20	930



Load limiter

European Remote control

Available — 3 phase, 415v & 380v, 50/60 Hz

Capacity (ton)		0.5	1	2	3	5	7.5	10	15	20	25	50
Dimensions (mm)	H	530	650	800	845	1030	1200	1400	1260	1320	1340	1965
	A	460	520	615	615	615	615	630	630	630	630	630
	B	230	260	295	295	295	295	315	315	315	315	315
	D	288	300	430	430	430	505	890	1070	1260	1460	1815
	E	178	176	265	265	325	320	445	535	630	725	855
	I	35	42	49	59	60	85	85	120	150	150	270
	N	28	32	40	48	48	80	80	96	115	115	165
	J								54	70	70	95
	U								560	740	930	760

0.5T-5T hoist with hook

10T hoist with hook

15-25T hoist with hook

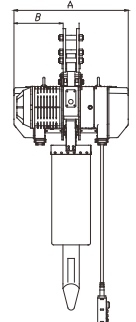
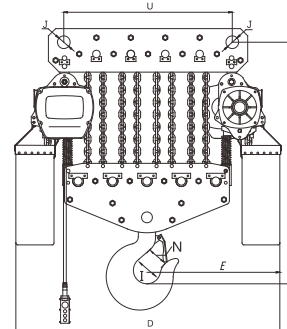
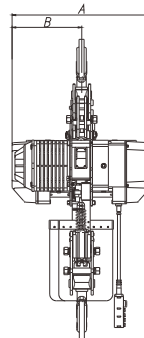
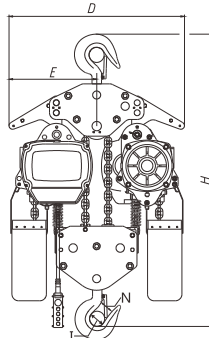
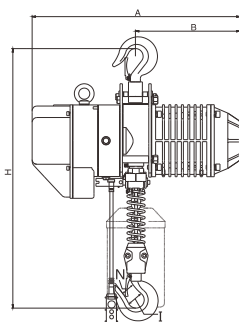
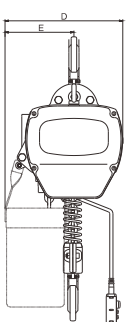

# ELECTRIC CHAIN HOIST

EPSSDHL - Electric chain hoist with trolley & Load limiter



Load limiter

European Remote control

## Technical Parameters

Capacity (ton)	Trolley running (Right&Left)		Hoist lifting (Up&Down)				Weight (kg)
	Running speed (m/min)	I-beam (mm)	Lifting speed (m/min)	Motor Power (kw)	Dia of Chain (mm)	chain falls	
0.5	21	58-153	7.2	0.8	6.3	1	78
1	21	58-153	6.6	1.5	7.1	1	115
2	21	82-178	6.6	3.0	10.0	1	167
3	21	100-178	4.4	3.0	10.0	2	195
5	21	100-178	2.7	3.0	11.2	2	238
7.5	21	100-178	1.8	3.0	11.2	3	297
10	21	152-220	2.7	3.0*2	11.2	4	491
15	21	152-220	1.8	3.0*2	11.2	6	706
20	21	152-220	1.4	3.0*2	11.2	8	816
25	21	152-220	1.1	3.0*2	11.2	10	834
30	21	152-220	0.9	3.0*2	11.2	12	1124
50	21	152-220	0.55	3.0*2	11.2	20	1224

Available — 3 phase, 415v & 380v, 50/60 Hz

Capacity (ton)		0.5	1	2	3	5	7.5	10	15	20	25	50
Dimensions (mm)	H	635	650	770	930	1015	1200	1400	1310	1470	1580	1965
	A	460	520	615	615	615	615	630	630	630	630	630
	B	230	260	295	295	295	295	315	315	315	315	280
	D	288	300	430	430	430	505	890	1070	1260	1460	1815
	E	178	176	265	320	325	320	445	535	630	725	855
	R	145	145	145	145	145	145	145	145	145	145	145
	T	235	235	235	235	235	235	235	235	235	235	235
	N	28	32	40	48	48	80	80	96	115	115	165
	W								926	1106	1280	
	U								560	740	930	760

0.5T-5T hoist with trolley

10T hoist with trolley

15-25T hoist with trolley

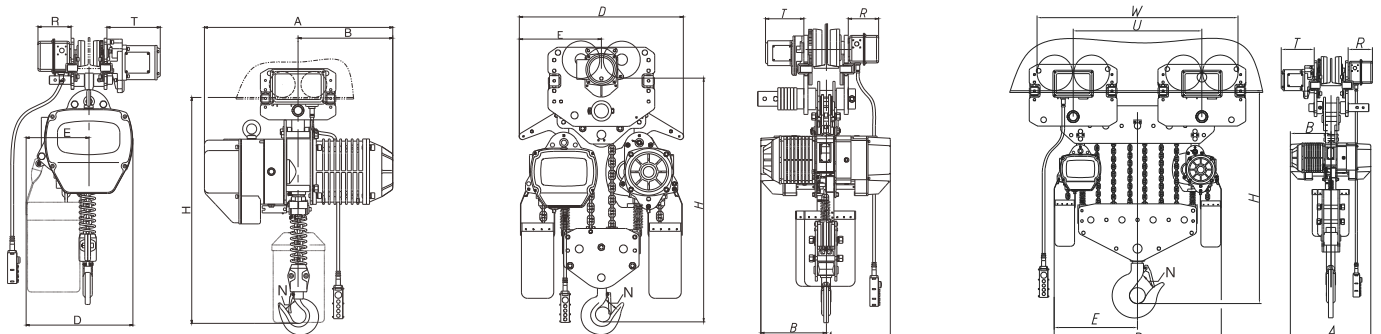

## ELECTRIC CHAIN HOIST ★

EPSSDHL - Low headroom Electric chain hoist & Load limiter

### Technical Parameters

Capacity (ton)	Hoist lifting(Up&Down)				Weight (kg)
	Lifting speed (m/min)	Motor Power (kw)	Dia of Chain (mm)	No. Of chain falls	
0.5	7.2	0.8	6.3	1	93
1	6.6	1.5	7.1	1	132
2	6.6	3.0	10.0	1	197
3	4.4	3.0	10.0	2	225
5	2.7	3.0	11.2	2	273
7.5	1.8	3.0	11.2	3	332
10	2.7	3.0*2	11.2	4	531



European Remote control

## ELECTRIC CHAIN HOIST

EPSSDHL - Wireless remote control Electric chain hoist & Load limiter

### Technical Parameters

Capacity (ton)	Hoist lifting(Up&Down)				Weight (kg)	Control meter (m)
	Lifting speed (m/min)	Motor Power (kw)	Dia of Chain (mm)	No. Of chain falls		
0.5	7.2	0.8	6.3	1	78	100
1	6.6	1.5	7.1	1	115	100
2	6.6	3.0	10.0	1	167	100
3	4.4	3.0	10.0	2	195	100
5	2.7	3.0	11.2	2	238	100
7.5	1.8	3.0	11.2	3	297	100
10	2.7	3.0*2	11.2	4	491	100
15	1.8	3.0*2	11.2	6	706	100
20	1.4	3.0*2	11.2	8	816	100
25	1.1	3.0*2	11.2	10	834	100
30	0.9	3.0*2	11.2	12	1124	100
50	0.55	3.0*2	11.2	20	1224	100

(Can operate from distance of 50-100mtr.)



Wireless Remote control

## ELECTRIC CHAIN HOIST ★

EPM - Electric chain hoist with trolley (M- series)

### Technical Parameters

Capacity (ton)	Hoist lifting(Up&Down)					Weight (kg)
	Single speed (m/min)	Converter speed (m/min)	Motor Power (kw)	Dia of Chain (mm)	Running Speed (m/min)	
0.25	9.1	0.91-9.1	0.56	4.0	21	65
0.5	8.3	0.83-8.3	0.9	6.3	21	118
1	6.3	0.63-6.3	1.5	7.1	21	167
2	6.9	0.69-6.9	3.0	10.0	21	206
3	4.3	0.43-4.3	3.0	10.0	21	249
5	3.3	0.33-3.3	3.0	11.2	21	297
7.5	2.2	0.22-2.2	3.0	11.2	21	491
10	3.3	0.33-3.3	3.0*2	11.2	21	706
15	2.2	0.22-2.2	3.0*2	11.2	20	816
20	1.65	0.165-1.65	3.0*2	11.2	20	834
25	1.13	0.13-1.3	3.0*2	11.2	20	1224
30	1.1	0.11-1.1	3.0*2	11.2	20	1473
50	0.66	0.066-0.66	3.0*2	11.2	20	1677



European Remote control

## ELECTRIC CHAIN HOIST

EPM - Electric chain hoist (M- Series)

### Technical Parameters

Capacity (ton)	Hoist lifting(Up&Down)					Weight (kg)
	Single speed (m/min)	Converter speed (m/min)	Motor Power (kw)	Dia of Chain (mm)	No. Of chain falls	
0.25	9.1	0.91-9.1	0.56	4.0	1	34
0.5	8.3	0.83-8.3	0.9	6.3	1	46
1	6.3	0.63-6.3	1.5	7.1	1	67
2	6.9	0.69-6.9	3.0	10.0	1	115
3	4.3	0.43-4.3	3.0	10.0	2	129
5	3.3	0.33-3.3	3.0	11.2	2	137
7.5	2.2	0.22-2.2	3.0	11.2	3	190
10	3.3	0.33-3.3	3.0*2	11.2	4	324
15	2.2	0.22-2.2	3.0*2	11.2	6	396
20	1.65	0.165-1.65	3.0*2	11.2	8	501
25	1.13	0.13-1.3	3.0*2	11.2	10	521
30	1.1	0.11-1.1	3.0*2	11.2	12	770
50	0.66	0.066-0.66	3.0*2	11.2	20	890



European Remote control

Available — 3 phase, 415v & 380v, 50/60 Hz

# MANUAL GEAR TROLLEY

## EPTGR - MANUAL GEARED TROLLEY

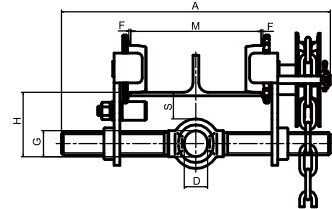
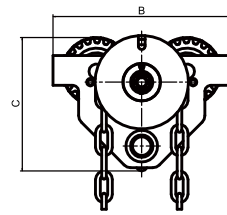

Model		EPTGR-0.5	EPTGR-1	EPTGR-2	EPTGR-3	EPTGR-5
Capacity(tons)		0.5	1	2	3	5
Proof load(KN)		6.3	12.5	25	38	63
Lifting height(mm)		25	50	90	100	140
Chain pull to lift rate load(N)		0.8	0.9	1	1.2	1.3
Min.radius curve(m)		328	340	344	363	386
Dimensions(mm)	A	420	425	437	457	466
	a	190	224	256	295	329
	B	145	172	202	240	268
	C	71	81	95	109	124
	H	31	27	27	27	31
	S	25	29	36	46	52
	D	28	37	48	56	65
	G			1.5~3		
I beam width(mm)	M	50-220	68-220	68-220	80-220	90-220
	a	50-305	68-305	68-305	80-305	90-305
Net weight (kg)	b	7.2	10.5	14.6	22.3	33
		7.6	11.5	15.4	23.3	34

# PLAIN TROLLEY

## EPTPR - PLAIN TROLLEY

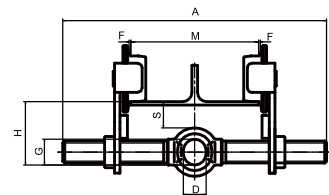
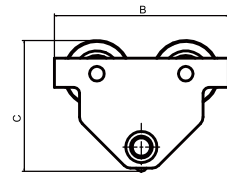

Model		EPTPR-0.5	EPTPR-1	EPTPR-2	EPTPR-3	EPTPR-5
Capacity(tons)		0.5	1	2	3	5
Proof load(KN)		6.3	12.5	25	38	63
Chain pull to lift rate load(N)		25	50	90	100	140
Min.radius curve(m)		0.8	0.9	1	1.2	1.3
Dimensions(mm)	A	287	300	304	328	359
	a	385	388	405	429	435
	B	190	224	256	295	329
	C	145	172	202	240	268
	H	71	81	95	109	124
	S	31	27	27	27	31
	D	25	29	36	46	52
	G	28	37	48	56	65
I beam width(mm)	M	50-220	68-220	68-220	80-220	90-220
	a	50-305	68-305	68-305	80-305	90-305
Net weight (kg)	b	4.2	7.4	11.6	18.5	29
		5	7.9	12.4	19.4	30

Standard: EN 13157 All dimensions are subject to change without prior notice

## PLAIN TROLLEY

### EPPT - PLAIN TROLLEY

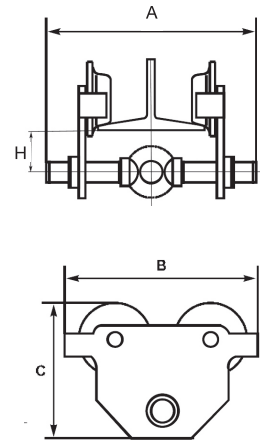
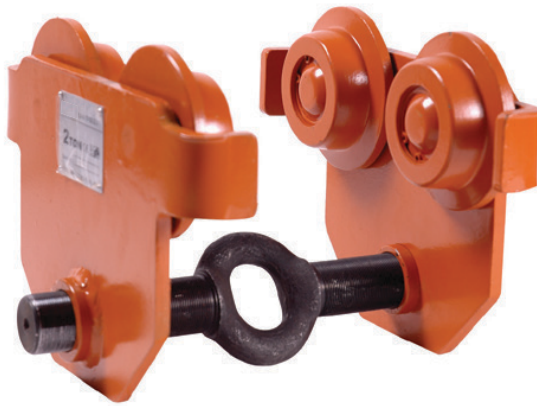

Push Trolley [Model : EPPT]							
Model	Capacity	I-Beam Width (mm)	N.W. (kg)	A (mm)	B (mm)	C (mm)	H (mm)
EPPT - 005	0.5 t	50-220	5	285	198	158	64.5
EPPT - 010	1t	58-220	8.7	300	238	183	66
EPPT - 020	2t	66-220	13.9	300	277	208	75
EPPT - 030	3t	74-220	23.5	328	324	249	85
EPPT - 050	5t	90-220	40	354	373	296.5	100

Standard: EN 13157 All dimensions are subject to change without prior notice

## MANUAL GEAR TROLLEY

### EPGT - MANUAL GEAR TROLLEY

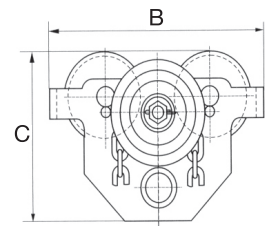
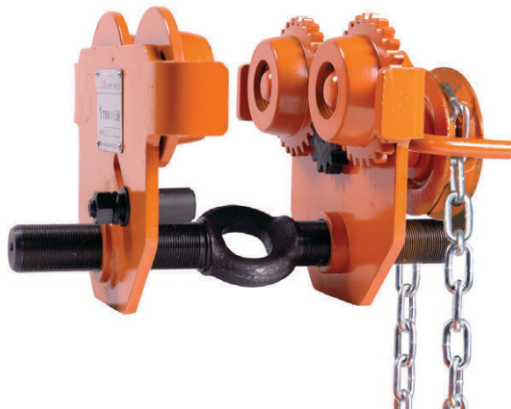

Gear Trolley [Model : EPGT]							
Model	Capacity	I-Beam Width (mm)	N.W. (kg)	A (mm)	B (mm)	C (mm)	H (mm)
EPGT - 005	0.5 t	50-220	9	352.5	198	158	64.5
EPGT - 010	1t	58-220	12.6	353.5	238	183	66
EPGT - 020	2t	66-220	18.5	362	277	208	75
EPGT - 030	3t	74-220	28	406.5	324	249	85
EPGT - 050	5t	90-220	45	434.5	373	296.5	100
EPGT - 100	10t	125-203	103	487.5	455	490	275.5

Standard: EN 13157 All dimensions are subject to change without prior notice

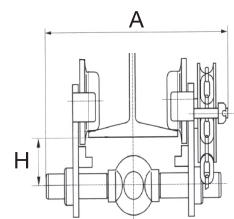



## RACK JACK (EP-RJ - MODEL)

### EP-RJ - RACK JACK

#### Characteristics

- » Top quality steel structure makes high safety and durability.
- » Equipped with fixed claw.
- » Collapsible handle for easy storage, operation and maintenance.
- » Fast lift speed makes it work more efficiently.

RACK JACK (MODEL:EP-RJ)					
Model		EP-RJ015	EP-RJ030	EP-RJ050	EP-RJ100
Capacity	(Ton)	1.5	3	5	10
Tested Load	(Ton)	2.25	4.5	7.5	15
Effort required to lift max. load	(N)	300	350	400	580
(Dimensions mm)	A	77	83	105	120
	B	100	130	145	145
	C	605-905	715-1085	730-1080	795-1160
	D	55-355	60-430	70-420	83-448
	E	55	60	70	80
	F	46	45	68	73
	G	110	135	170	170
	H	225	285	285	330
	K	121	200	190	252
	R	119	140	155	185
S	185	230	220	220	
T	126	126	126	255	
Net weight	(Kg)	10.7	21.3	27	47

Standard: EN 1494:2000

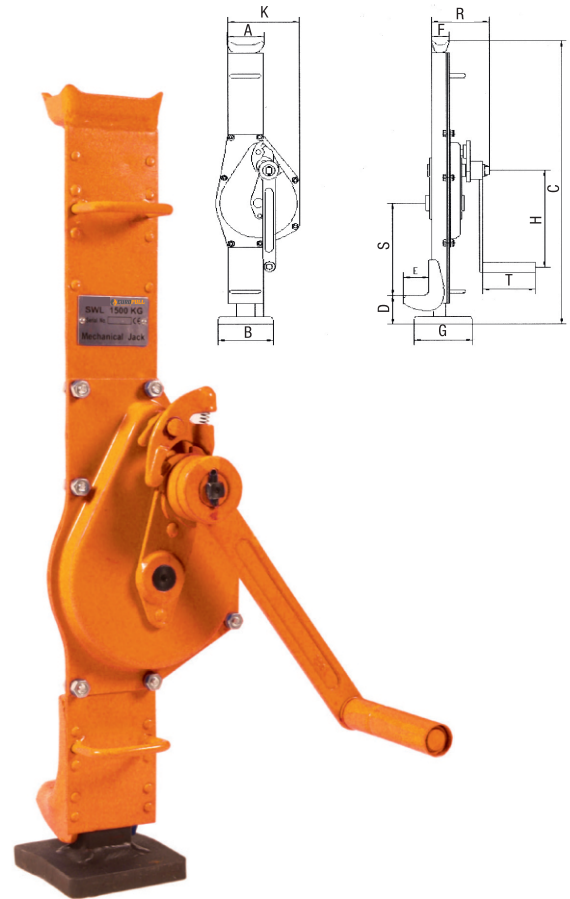

## SNATCH BLOCK

### EP-SB - SNATCH BLOCK

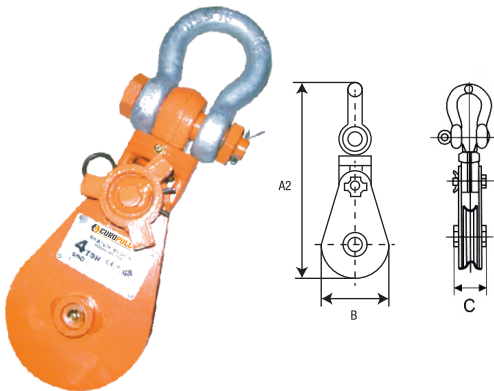

WIRE ROPE SNATCH BLOCK WITH SHACKLE [MODEL: EP- SB]							
Model	Capacity (Ton)	Sheave Dia (mm)	A2 (mm)	B (mm)	C (mm)	Wire Rope (mm)	Net Weight (kg)
EP-SB020	2	75	286	82	70	7-9	4
EP-SB040	4	115	345	120	70	10-12	5.68
EP-SB080	8	150	475	160	93	20-22	14.4
EP-SB100	10	245	672	250	110	24-26	37.5
EP-SB120	12	250	679	260	115	24-26	37.5
EP-SB150	15	300	788	310	133	26-28	65
EP-SB220	22	355	952	365	140	28-32	90
EP-SB300	30	400	1126	415	155	32-35	135
EP-SB300	30	500	1256	514	162	32-35	210

- Drop forged, heat treated swivel shackle
  - Safety factor 4:1
  - Shackle (EP-2130 type)
- Standard: EN 13157

## WIRE ROPE CLIP U BOLT TYPE

- » Entire Rope Clip is Galvanized to resist corrosive and rusting actions
- » Size available from 1/4" to 3" (Galvanized)
- » Top quality steel structure makes high safety and durability.
- » Standard: Federal Specification FF-C-450
- » Significantly, these wire rope clips meet additional critical performance requirements, impact properties, and material traceability.



# HORIZONTAL PLATE LIFTING CLAMP

## EP-FHX - HORIZONTAL PLATE LIFTING CLAMP

TYPE	Capacity per pair (Ton)	Jaw opening (mm)	Dimensions (mm)						Weight (Kg)
			A	B	C	D	E	F	
EP-FHX010	1	0-60	210	165	80	12	110	25	6
EP-FHX015	1.5	0-60	285	180	80	14	120	25	6.5
EP-FHX020	2	0-60	285	180	80	15	120	25	7.5
EP-FHX030	3	0-60	303	220	90	18	145	30	10
EP-FHX050	5	0-60	309	220	110	25	135	30	15.5
EP-FHX100	10	0-60	330	225	110	25	140	40	23

Standard: EN 13155



All dimensions are subject to change without prior notice

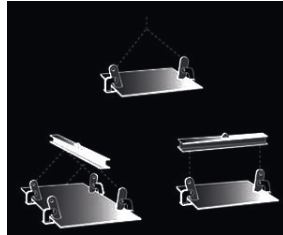
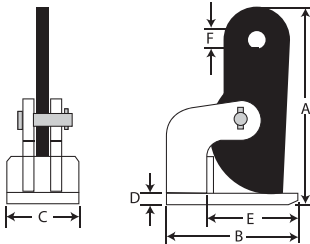

# BEAM CLAMP

## EP-BC - BEAM CLAMP

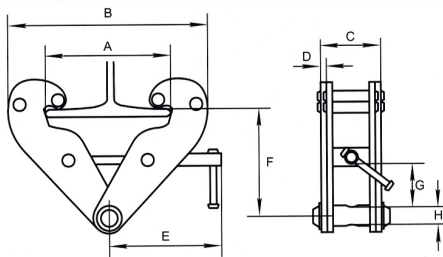

BEAM CLAMP (MODEL: EP-BC)						
Model		EP-BC010	EP-BC020	EP-BC030	EP-BC050	EP-BC100
Rated Load	(Ton)	1	2	3	5	10
Tested Load	(Ton)	1.5	3	4.5	7.5	15
Flange width	mm	75-220	75-220	80-320	80-320	90-320
(Dimensions mm)	Max. A	260	260	354	354	365
	Min. B	180	180	235	235	320
	Max. B	260	360	490	490	505
	C	72	76	103	110	120
	D	5	6	8	10	12
	E	215	215	260	260	280
	Max. F	155	155	225	225	235
	Min. F	102	102	140	140	170
	Min. G	25	25	45	45	50
H	22	22	24	28	40	
Net weight	Kg	3.8	4.6	9	11	16

Standard: EN 13155

# HORIZONTAL PIPE LIFTING CLAMP

(SUPPLIED WITH SHACKLE)

## EP-PLC - HORIZONTAL PIPE LIFTING CLAMP

Model	Capacity per pair (Ton)	Jaw opening (R) (mm)	Dimensions (mm)						Weight (Kg)
			A	B	C	D	E	F	
EP-PLC015	1.5	40	125	30	220	70	35	27	2
EP-PLC030	3	40	140	32	228	70	35	27	2.9
EP-PLC040	4	50	145	32	228	70	40	30	4
EP-PLC060	6	50	150	35	232	70	40	30	5
EP-PLC080	8	70	155	35	260	70	40	30	6.7
EP-PLC120	12	70	175	35	322	70	45	33	10
EP-PLC160	16	70	175	35	322	70	55	40	13

Standard: EN 13155

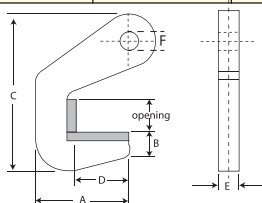

## PLATE & BEAM LIFTING CLAMPS

### EP-VC - HORIZONTAL PLATE LIFTING CLAMP

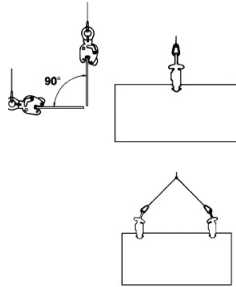

VERTICAL LIFTING CLAMP (MODEL: EP-VC)				
Model	Capacity (Ton)	Jaw opening size (mm)	Test load (Ton)	Net weight (Kg)
EP-VC008	0.8	0-15	1.6	2
EP-VC016	1.6	0-20	3.2	7.6
EP-VC032	3.2	0-25	6.4	16.2
EP-VC080	8	0-45	16	34
EP-VC120	12	50-90	24	50
EP-VC160	16	60-100	32	65

Standard: EN 13155

## HORIZONTAL LIFTING CLAMP

### EP-HC - HORIZONTAL LIFTING CLAMP

HORIZONTAL LIFTING CLAMP (MODEL: EP-HC)							
Model		EP-HC015	EP-HC020	EP-HC030	EP-HC004	EP-HC060	EP-HC 100
Rated capacity	(Ton /pair)	1.5	2	3	4	6	10
Test load	(Ton /pair)	3	4	6	8	12	20
Jaw Opening	(mm)	0-25	0-30	0-30	0-40	0-45	0-55
Dimensions (mm)	A	126	148	155	172	180	180
	B	165	205	206	245	245	260
	C	50	65	65	68	70	74
	D	42	48	48	58	58	58
	E	22	25	25	30	30	30
Net weight	(Kg/Pair)	5	7	8	10	12	15

Standard: EN 13155

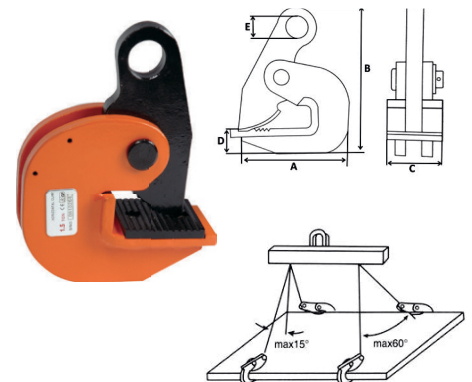

## VERTICAL LIFTING CLAMP

### EP-LC - VERTICAL LIFTING CLAMP

VERTICAL LIFTING CLAMP (MODEL: EP-LC)					
Model		EP-LC010	EP-LC020	EP-LC030	EP-LC050
Capacity	(Ton)	1	2	3	5
Tested Load	(Ton)	2	4	6	10
Jaw Opening	(mm)	0-22	0-30	0-40	0-50
Dimensions (mm)	A	25	35	45	55
	B	33	40	50	55
	C	129	155	182	245
	D	50	55	60	68
	E	25	35	37	45
	F	220-260	255-300	305-370	375-435
	G	30	35	44	58
	H	144	170	210	247
	I	54	60	73	77
	J	14	16	18	18
Net weight	Kg	3.6	5.5	10	17

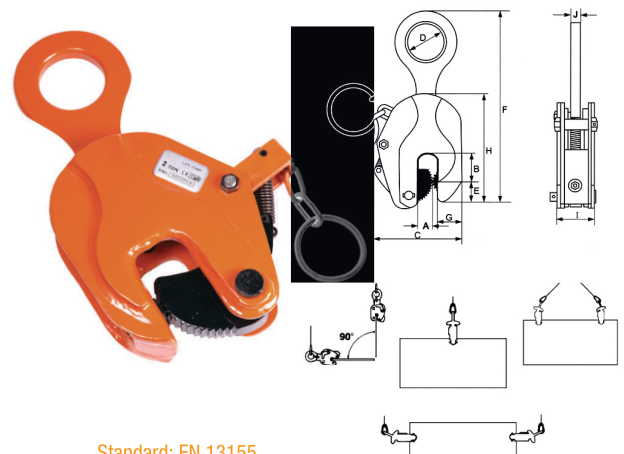

Standard: EN 13155

## TURN BUCKLES

★ Range - 1/4 X 4" to 2-3/4" x 24"

TURN BUCKLES - EP - 226  
EYE & EYE



TURN BUCKLES - EP - 227  
JAW & EYE



TURN BUCKLES - EP - 228  
JAW & JAW



## ALLOY SHACKLES

- » Entire Europull Shackle is Galvanized to resist corrosive and rusting action.
- » Significantly, these Europull Shackles meet additional critical performance requirements, including fatigue life, impact properties, and material traceability.

### FORGED ALLOY STEEL AND HOT DIP GALVANIZED, EUROPULL RED COLOR SCREW PIN SHACKLES, TESTED AND CERTIFIED

Size	S.W.L	A	B	C	D		Weight Kgs/each
			Pin Dia.		BOW	DEE	
Inch	Tons	mm	mm	mm	mm	mm	
3/8"	1.00	9.5	11	17	36.5	32	0.15
7/16"	1.50	11	12	18	42.5	36.5	0.21
1/2"	2.00	12.7	16	20.6	47.3	41.3	0.37
5/8"	3.25	16	19.8	27	60.5	51	0.65
3/4"	4.75	19	22	32	71.5	62	1.04
7/8"	6.50	21.7	27	36.6	84	74.8	1.56
1"	8.50	25.4	30	43	96	81	2.32
1 1/8"	9.50	28.5	33	46	108	90	3.28
1 1/4"	12.00	31.5	36	51.6	119	100.8	4.51
1 3/8"	13.50	34.9	39	57	133.5	112.5	5.93
1 1/2"	17.00	38	42	60	147	125	7.89
1 3/4"	25.00	44	52	73	178	146.5	13.4
2"	35.00	50	56	82	197	171	18.85
2 1/2"	55	63.5	68	105	267.5	203	37.86

### SCREW PIN BOW SHACKLES EP-209

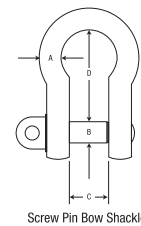

Screw Pin Bow Shackle



### SCREW PIN DEE SHACKLES EP-210

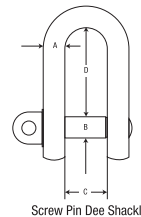

Screw Pin Dee Shackle



Standard: In accordance with EN 13889 These items meet the performance requirements of US FED Specification

## SAFETY PIN BOW SHACKLES

- » Entire Europull Shackle is Galvanized to resist corrosive and rusting action.
- » Significantly, these Europull Shackles meet additional critical performance requirements, including fatigue life, impact properties, and material traceability.

### FORGED ALLOY STEEL AND HOT DIP GALVANIZED, EUROPULL RED COLOR SAFETY PIN SHACKLES, TESTED AND CERTIFIED

Size	S.W.L	A	B	C	D	Weight Kgs/each
			Pin Dia.		BOW	
Inch	Tons	mm	mm	mm	mm	
3/8"	1.00	9.5	12	17	36.5	0.17
7/16"	1.50	11	12	18	42.5	0.25
1/2"	2.00	12.7	16	20.6	47.3	0.44
5/8"	3.25	16	19.8	27	60.5	0.79
3/4"	4.75	19	22	32	71.5	1.26
7/8"	6.50	22	27	36.6	84	1.88
1"	8.50	25	30	43	96	2.78
1 1/8"	9.50	28.5	33	46	108	3.87
1 1/4"	12.00	31.8	36	51.6	119	5.26
1 3/8"	13.50	34.9	39	57	133.5	6.94
1 1/2"	17.00	38	42	60	147	8.79
1 3/4"	25.00	44	52	73	178	14.99
2"	35.00	50	56	82	197	20.65
2 1/2"	55.00	63.5	68	105	267	41.05
3"	85.00	75	85	127	320	62.00
3 1/2"	120	89	95	146	381	110
4"	150	102	108	165	400	160
4 3/4"	200	120	130	175	500	235

### SAFETY PIN BOW SHACKLES EP-2130

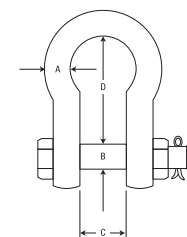
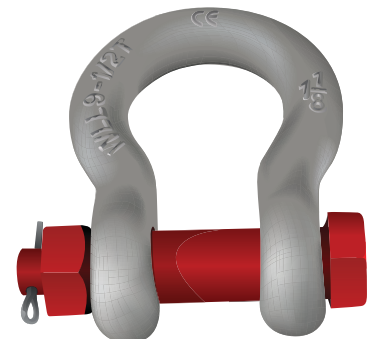

Safety Pin Bow Shackle

Standard: In accordance with EN 13889 These items meet the performance requirements of US FED Specification

# HAND PALLET TRUCK

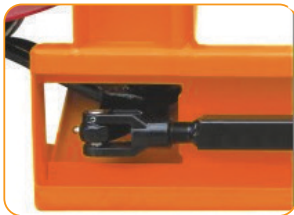
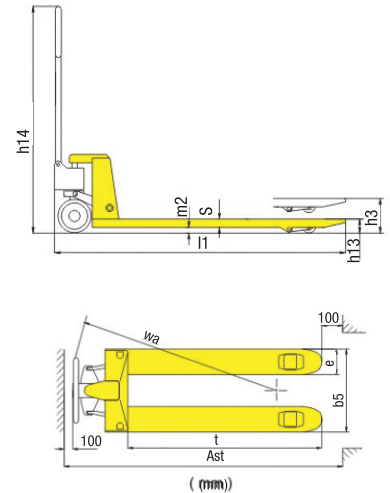

Adjustable straight tappet



Adjustable pump cap



Entry roller for easy operation



Option; fully rubber wrapped handle

## Key Features:

- » Construction & Frame: Forged High Tensile Heavy-duty steel, channel steel construction for strength, with reinforced forks and steel hangers.

### Hydraulics:

- » Quick-Lift: Reaches maximum lift in a few strokes (e.g., 10-12 strokes).
- » Controlled Lowering: Special valve for smooth, controlled descent.

### Operator Comfort & Control:

- » Ergonomic Handle: Cushioned, rubber-wrapped, with a spring-loaded return to upright.
- » 3-Position Control: Finger-tip lever for Raise, Lower, & Neutral.

Model		EP-BF25	EP-BF35	EP - B50
Capacity	Ton	2.5	3.5	5
Service weight	kg	70	90	105
Steering wheel	mm	ø200	ø180	ø200
Fork wheel	mm	ø80	ø75	ø84
Max. lift height	h3(mm)	185	175	195
Total height	h14(mm)	1224	1214	1240
Lowered fork height	h13(mm)	85	75	88
Overall length	l1(mm)	1533/1603	1533/1603	1533/1603
Fork dimension	s/e/t	50/160/1150	50/160/1150	60/160/1150
Distance between fork-arms outside	b5(mm)	550	550	550
Ground clearance centre of wheel base	m2(mm)	16	16	16
Aisle width for pallets 1000x1200 crossways	Ast(mm)	1730/1800	1730/1800	1730/1800
Aisle width for pallets 800x1200 lengthways	Ast(mm)	1730/1800	1730/1800	1730/1800
Turning radius	Wa(mm)	1266/1336	1266/1336	1266/1336

Standard: EN ISO 3691-5: 2014

# EPYTG LOW HEADROOM HOIST ★

## EPYTG LOW HEADROOM HOIST

### Make by Standard: EN13157

The EPYTG Low Headroom hoist is the ideal solution to meet your toughest clearance requirements for special applications. This hoist is custom built to fit long or short reach framing. Using special trolley frame with upper sheave and offset hoist machinery, lifting heights can be optimized. Allows for maximum hook height in tight clearance applications.

### Easy Operation

- » Capacity range from 1 ton to 10 ton.
- » Ultra-low headroom design for maximum hook travel.
- » Extremely low headroom for use where space is limited.
- » Efficient hoist drive train minimizes effort required to operate.
- » Trolley wheels fit on both tapered and flat flanged beams.
- » Maintenance-free sealed trolley ball bearings are lubed life and offer smooth movement with low friction and long life.
- » 20' standard lift. Longer lengths available Dependability.

### Dependability

- » All-steel construction for hoist durability.
- » Reliable hoist braking with double enclosed brake cover that keeps out rain, dust and dirt.
- » Grade80 heat-treated manganese alloy load chain resists abrasion and wear.
- » Cast trolley wheels and steel side plates for heavy-duty applications.

### Applications

- » Industrial lifting applications where space is limited.
- » Demanding environments.

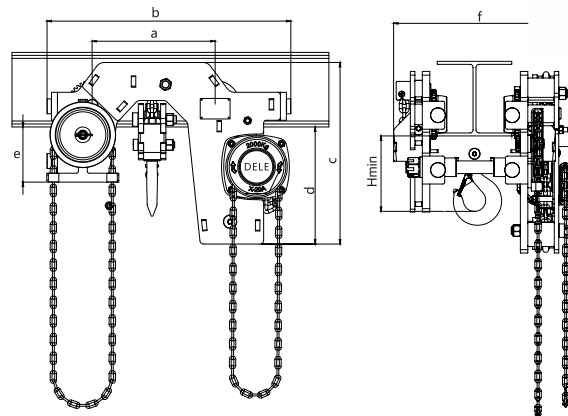

EPYTG1T - EPYTG10T

### Technical details

Model		EPYTG-1T	EPYTG-2T	EPYTG-3T	EPYTG-5T	EPYTG-10T
Capacity load	(t)	1	2	3	5	10
Standard lift	(m)	3	3	3	3	3
Effort required to lift max load		305	340	350	370	380
Test load	(N)	1250	2500	3750	6250	12500
Load chain specifications	(kg)	5x15	6x18	8x24	10x30	10x30
Hand chain specifications	(mm)	5x25	5x25	5x25	5x25	5x25
Gross weight	(kg)	41.4	60.1	93.5	134.8	140.91
Net weight	(kg)	34.2	49.6	81.8	118	126.91
Packing size	(cm)	52.2*45*36.3	60.9*48.4*42.3	69.4*52.8*52.7	78.3*58.7*63.2	78.3*58.7*63.2
Add 1m weight	(kg)	1.08	1.54	2.72	4.4	8.8
The minimum clearance	(mm)	166	192	217	290	303
Beam width (hmin)	(mm)	50-305	74-305	85-305	85-305	85-305
	a	238	280	330	375	480
	b	482	569	654	743	916
	c	323	393	487	592	580
	d	209	249	314	367.5	373
	e	112	134	148	149	181
	f	410	444	488.5	547.5	557.2
	Hmin	148	166	202	239	301

## UNIVERSAL BEAM CLAMP / SUPER CLAMP ★

Universal beam clamp has been designed not only for vertical use, but also for side load applications, where conventional clamps are not suitable.

- » The Universal beam clamp is suitable for pulling and lifting at angles across the beam or as a semi-permanent anchor point.
- » It can be loaded at any angle and eliminates the use of spreader beams in various lifting operations.
- » Fitted with an adjustable locking mechanism, ensuring secure clamping to the beam.
- » Built-in suspension point for low headroom design.
- » Light weight design allowing for quick clamping and unclamping.

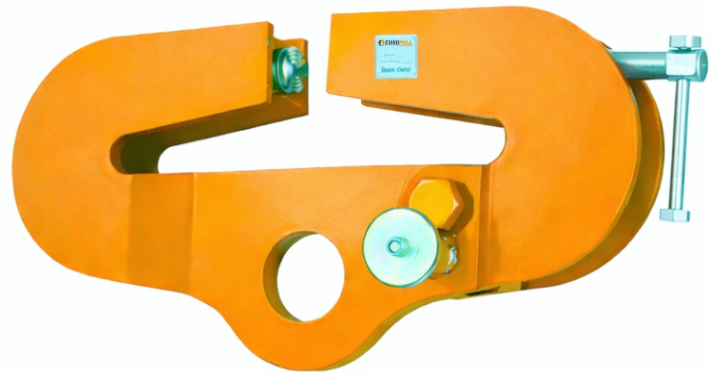

**Make by Standard: EN131!**

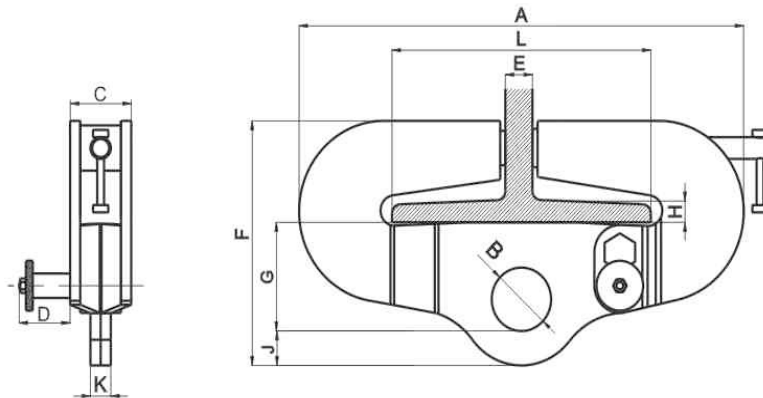

Model	WLL (t)	A(mm)	B(mm)	C(mm)	D(mm)	E(mm)	F(mm)	G(mm)	H(mm)	J(mm)	K(mm)	L(mm)	Net Weight(kg)
EPBC -2	2	375	58	70	57	32	217	93	25	23	16	125-204	10.6
EPBC -3	3	387	60	70	57	32	235	100	25	28	20	125-204	12.50
EPBC -5	5	527	70	74	60	32	270	120	25	38	24	125-305	20.50
EPBC-10	10	527	70	74	60	32	278	120	25	38	24	125-305	24.50

## EPSL - DRUM LIFTER / DRUM CLAMP

- » For safe lifting and transporting of steel (oil) drums.
- » With automatic locking mechanism.
- » The DSL steel drum clamps can be used single or per pair as well.
- » Avoid snatch or shock loading.
- » Clamps firmly on 2-leg Grade 80 lifting chain.
- » This clamp is extremely light weight and very quick and easy to use.



Model	WLL (t) per pair	Jaw Opening(mm)	Net Weight(kg)
EPSL -1	1.0	1-13	2.1
EPSL -2	2.0	3-22	4.7

# EPSSL ALUMINUM / WIRE ROPE PULLEY MACHINE

## EPSSL ALUMINUM WIRE ROPE PULLEY MACHINE

### ADVANTAGES OF THE WIRE ROPE PULLEY MACHINE

- › Simple structure and powerful function  
Fast and easy installation, simple to feed in or remove the wire rope, continuous operation without snatching, change over from forward to reverse operation by transferring the operating handle from one lever to another, works in any position horizontal, vertical or angled.
- › The length of the wire rope is not limited  
Standard length of steel wire rope is 20 meters but custom length are available on request.
- › Safe and reliable  
Each winch is tested to 1.5 times of the rated capacity. The jaws and connecting axle have been quenched, and the modules have been electroplated. The performance of the products will not be affected after the four-fold.



### EPSSL TW800

Model	Rated capacity	Lever Pull at rated Load	Forward Travel	Wire Rope Diameter	Safety factor	Pulling Capacity	Net Weight (Body)	Net Weight (20m Wire Rope)	Net Weight (Lever Handle)
EPSSL-TW800	800kg	332N	≥52mm	8.3mm	5	1200kg	6.4kg	7kg	1.2kg
Max overall Size(mm)	A	B	C	D	E	F	G		
	44	60	101	420	430	172	240		

- Chassis: High strength 104 aluminum alloy
- Shell surface treatment: Spray, standard for sand gray, color can be customized
- Jaw blocks: Using 40Cr, suitable hardness after quenching that does not damage the wire rope and can ensure safety
- Wire rope: Hot dip galvanized, structure 6x19W+IWR-8.3MM, the standard 20 meters, strength 1770Mpa, length can be customized
- Wire rope hook: Standard American eye hook, material 35CrMo, high tensile strength. Swivel hook or European hook can be used as required



### EPSSL-TW1600

Model	Rated capacity	Lever Pull at rated Load	Forward Travel	Wire Rope Diameter	Safety factor	Pulling Capacity	Net Weight (Body)	Net Weight (20m Wire Rope)	Net Weight (Lever Handle)
EPSSL-TW1600	1600kg	445N	≥55mm	11mm	5	2400kg	12.4kg	11.5kg	2.5kg
Max overall Size(mm)	A	B	C	D	E	F	G		
	56	68	120	545	556	200	270		



### EPSSL-TW3200

Model	Rated capacity	Lever Pull at rated Load	Forward Travel	Wire Rope Diameter	Safety factor	Pulling Capacity	Net Weight (Body)	Net Weight (20m Wire Rope)	Net Weight (Lever Handle)
EPSSL-TW3200	3200kg	441N	≥28mm	16mm	5	4800kg	21.2kg	22.5kg	2.5kg
Max overall Size(mm)	A	B	C	D	E	F	G		
	70	98	150	645	666	227	320		



### EPSSL-TW5400

Model	Rated capacity	Lever Pull at rated Load	Forward Travel	Wire Rope Diameter	Safety factor	Pulling Capacity	Net Weight (Body)	Net Weight (20m Wire Rope)	Net Weight (Lever Handle)
EPSSL-TW5400	5400kg	745N	≥30mm	20mm	5	8000kg	58kg	32.6kg	3.7kg
Max overall Size(mm)	A	B	C	D	E	F	G		
	90	160	200	935	940	300	410		

# EPLV PORTABLE GANTRY SYSTEM ★

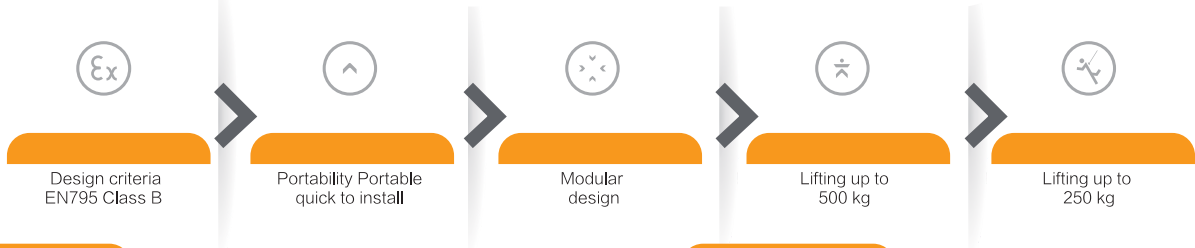

**A**

### LOAD-TROLLEY

Simple and quick installation  
Wheels are made of high-strength nylon



**B**

### QUICK-RELEASE LATCH

Transform Quick Release Pin Only  
No additional tools required  
Plug and unplug through 6 pins  
Installation takes less than 1 minute



**C**

### COMPACTNESS

Foldable aluminum alloy structural composition  
Compact when folded for portability



**D**

### PACKAGE AND TRANSPORTATION

Choice of professional packaging accessories  
Make transportation more convenient



**E**

### PORTABLE

Transport and carry only 1-2 persons  
Weight only 33 kg

# EPLV PORTABLE GANTRY SYSTEM ★

Lightweight, convenient and safe lifting equipment

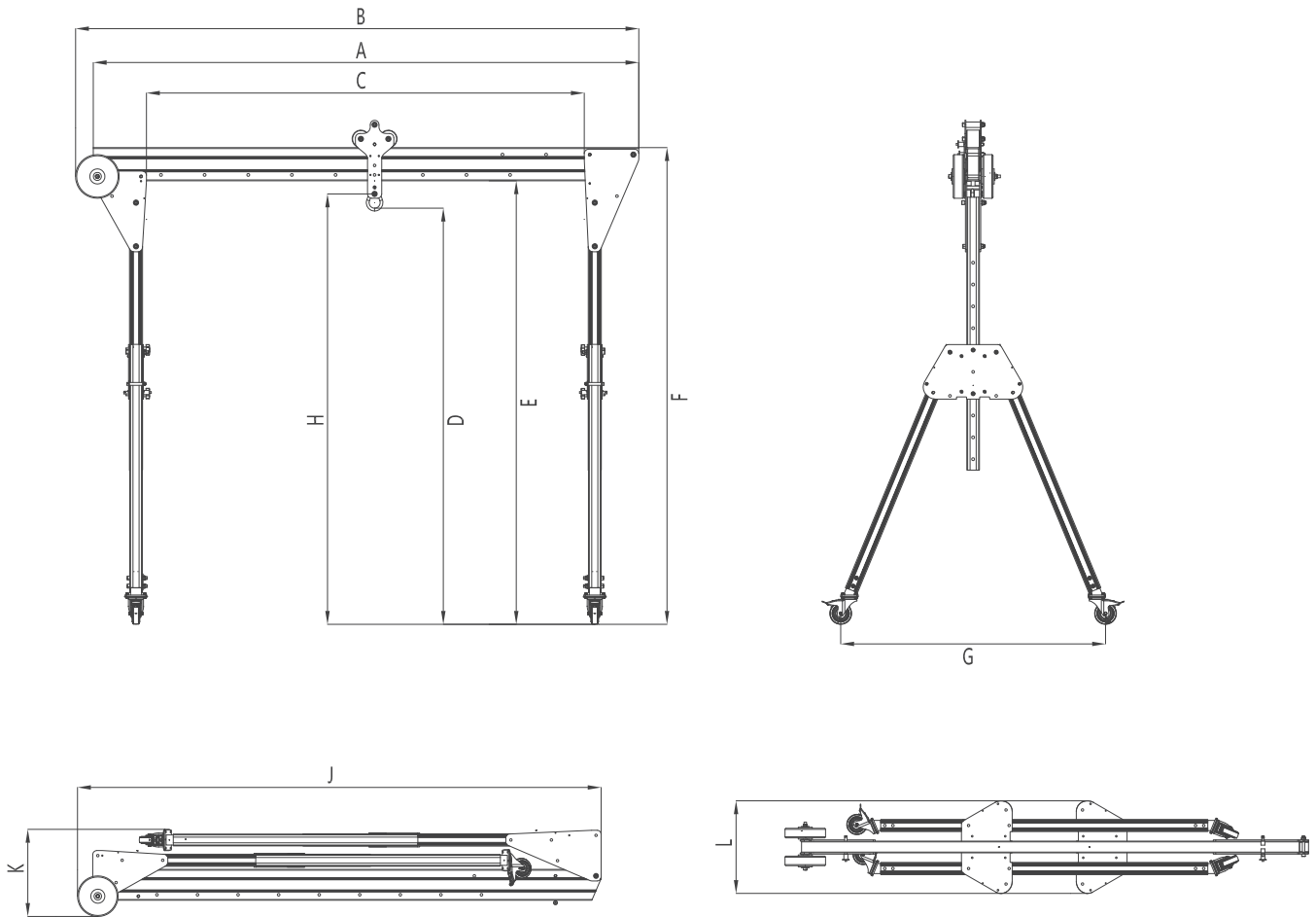

## Technical parameters

Model	WLL (kg)	Lifting human		Dimension parameter(mm)										Net weight (kg)
		Capacity (kg)	Number	A	B	C	E	F	G	J	K	L	H	
EPLVS 20	500	250	3	2000	2076	1100-1500	1914-2114	2064-2264	1158	2190	415	440	1850-2050	35
EPLVS 23	400	200	2	2300	2376	1200-1800				2376				38
EPLVS 40	250	125	1	4000	4076	2700-3500				4076				42
EPLVM 20	400	200	2	2000	2076	1100-1500	1818-2218	1968-2368	1215	2076	415	440	1755-2155	36
EPLVM 23	400	200	2	2300	2376	1200-1800				2376				37
EPLVM 40	250	125	1	4000	4076	2700-3500				4076				42
EPLVM 20	250	125	1	2000	2076	1100-1500	2092-2992	2242-3142	1586	2631	415	440	2028-2928	40
EPLVT 23	250	125	1	2300	2376	1200-1800				2631				41
EPLVT 40	250	125	1	4000	4076	2700-3500				4076				46
EPLV1S 20	1000	500	3	2000	2077	1102-1502	1661-2161	1822-2322	1270	2077	464	536	1549-2049	48
EPLV1S 30	1000	500	3	3000	3077	1902-2502				3077				56
EPLV1S 40	500	500	3	4000	4077	1902-3502				4077				61
EPLV1M20	1000	500	3	2000	2077	1102-1502	1900-2600	2061-2761	1484	2200	464	536	1859-2559	52
EPLV1M30	1000	500	3	3000	3077	1902-2502				3077				57
EPLV1M40	500	500	3	4000	4077	1902-3502				4077				62
EPLV1T 20	1000	500	3	2000	2077	1102-1502	2140-3040	2301-3201	1698	2830	464	536	2099-2999	56
EPLV1T 30	1000	500	3	3000	3077	1902-2502				3077				61
EPLV1T 40	500	500	3	4000	4077	1902-3502				4077				65



## EPJM /BUILDING ELECTRC WINCH ★

### Features:

- » This series electric winch can be mainly used in lifting, disassemble, moving and installing points in buildings site , digging and workshops.With strong pull. Wire rope arranged in order, safe and reliable.
- » Building winch or Electric Building winch is commonly used in construction projects and industrial sector

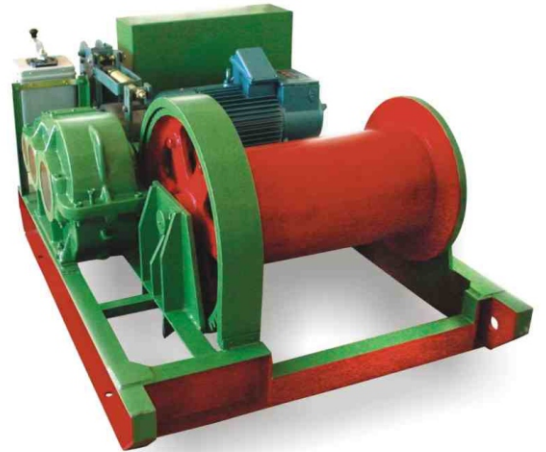
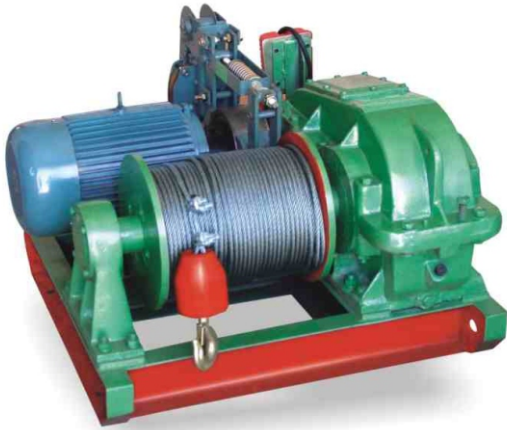

### Technical Parameters

Model	Rated speed (m/min)	Transmission type	Speed ratio	Outside diameter of rope drum	Inside diameter of rope drum	Drum size (mm)	Rope diameter (mm)	Wire rope capacity (m)	Arrester type	Machine weight (kg)	Motor type (kw)	Size (mm)
EPJM -1T	12	Four-axis 320	90:1	320	160	440	9.3	100	Electromagnetic 150	200	5.5-4	800*700*450
EPJM -2T	12	Four-axis 430	90:1	400	180	500	12	150	Electromagnetic 200	380	11-4	1000*1000*550
EPJM -3T	12	Four-axis 480	90:1	400	220	600	12	150	Hydraulic pressure 200	480	15-4	1100*1100*550
EPJM -5 T	12	Four-axis 620	90:1	620	300	600	15	150	Hydraulic pressure 300	1000	15-6	1200*1200*600
EPJM -5T	8	Four-axis 620	90:1	620	300	600	15	150	Hydraulic pressure 300	800	YZR 11-6	1200*1200*600
EPJM -8T	8	Four-axis 750	175:1	720	425	1000	22	150	Hydraulic pressure 300	1800	YZR 18.5-6	1700*1700*900
EPJM -10T	8	Four-axis 790	175:1	720	425	1100	25	150	Hydraulic pressure 300	2000	YZR 22-6	1800*1800*900 1900*1900*900
EPJM16-20T	8	Five-axis 1100	250:1	1000	525	1300	32	150	Hydraulic pressure 400	4000	YZR 37-6 YZR 45-6	2200*2200*1350

## MANUAL TROLLEY

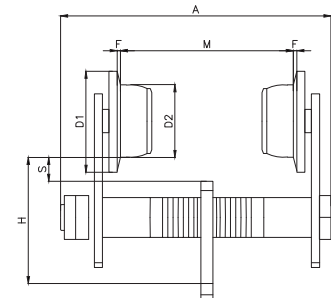
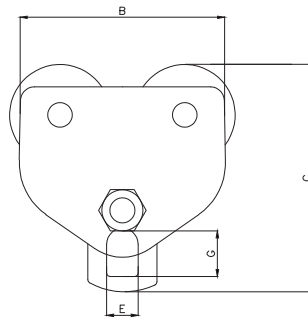

## EPTP - TYPE PLAIN TROLLEY

Model	Rated capacity (t)	Min. Curve Radlue (m)	Beam Flange Width(mm)		Dimensions(mm)											Net Weight(kg)	
					M		A		B	C	D1	D2	F	E	G		
			a	b	a	b	a	b									
EPTP 0.5	0.5	0.8	68-140	82-203	220	285	192	175	Φ78	Φ57	1.5-3	23	37	95	25	4.8	5.1
EPTP 1	1.0	0.9	80-146	64-203	230	295	213	191	Φ84	Φ60	1.5-3	24	38	107	21	7	7.4
EPTP 2	2.0	1.0	80-168	68-203	275	310	255	233	Φ102	Φ75	1.5-3	29	45	128	29	13	13.3
EPTP 3	3.0	1.2	88-168	102-203	285	325	320	282	Φ120	Φ90	1.5-3	36	65	153	22	20.2	20.5
EPTP 5	5.0	1.3	114-203		335		380	343	Φ141	Φ110	1.5-3	45	75	216	31	34	
EPTP 10	10.0	1.6	125-203		375		454	477	Φ189	Φ150	1.5-3	70	110	262	32	79	

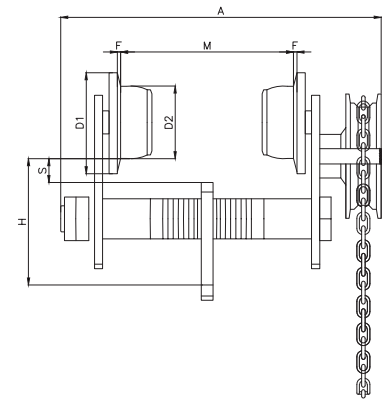
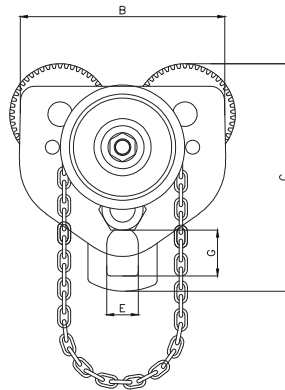

## EPTG - TYPE GEARED TROLLEY

Model	Rated capacity (t)	Min. Curve Radlue (m)	Beam Flange Width(mm)		Dimensions(mm)											Net Weight(kg)	
					M		A		B	C	D1	D2	F	E	G		
			a	b	a	b											
EPTG 0.5	0.5	0.8	68-140	82-203	262	317	192	175	Φ78	Φ57	1.5-3	23	37	95	25	8.4	8.7
EPTG 1	1.0	0.9	80-146	64-203	266	327	213	191	Φ84	Φ60	1.5-3	24	38	107	21	10.8	11.5
EPTG 2	2.0	1.0	80-168	68-203	312	351	255	233	Φ102	Φ75	1.5-3	29	45	128	29	16	17
EPTG 3	3.0	1.2	88-168	102-203	324	364	320	282	Φ120	Φ90	1.5-3	36	65	153	22	23.5	24.8
EPTG 5	5.0	1.3	114-203		358		380	343	Φ141	Φ110	1.5-3	45	75	216	31	37.5	
EPTG 10	10.0	1.7	125-203		412		454	477	Φ189	Φ150	1.5-3	70	110	262	32	92	
EPTG 20	20.0	3.5	125-203		453		550	567	Φ225	Φ168	1.5-3	76	115	315	40	180.3	
EPTG 30	30.0	6	125-203		463		630	645	Φ255	Φ196	1.5-3	90	130	354	39	252	

## CALIBRATED HOIST CHAIN ★

### CALIBRATED HOIST CHAIN(GRADE 80) STANDARD EN818-7

According to the user needs to provide hot-dip zinc, dacromet, metal coated, black, oil and various, surface treatments on the chain.

Safety Assurance: 4-fold safety factor of 2.5 times the proof load.

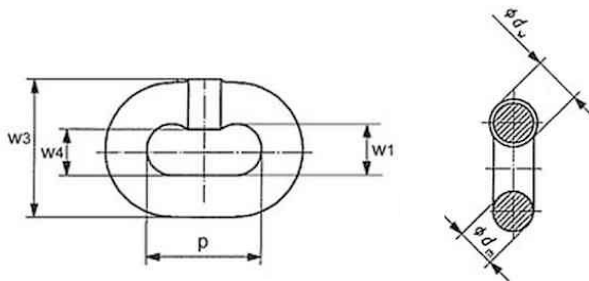

Size dxp (mm)	Width		Approx Weight (kg/m)	Working Load Limit (t)	Test Load (KN)	Breaking Load min.KN
	Inside min.w1	Outside max.w3				
3x9	3.8	10.2	0.21	0.28	7.1	11.3
4x12	5	13.6	0.35	0.5	12.6	20.1
5x15	6.3	17	0.54	0.8	19.6	31.4
6x18	7.5	20.4	0.79	1.1	27	45.2
6.3x19	7.9	20.4	0.86	1.25	31.2	49.9
7.1x21	9	23.8	1.07	1.5	37	61.6
8x24	10	27.2	1.38	2	48	80.4
9x27	11.3	30.6	1.76	2.5	63.6	102
10x30	12.5	34	2.2	3.2	76	125
11.2x34	14	37.4	2.71	4	98.5	158
12.5x38	15.5	40.8	3.3	4.9	117	196
13x39	16.3	44.2	3.8	5.3	128	214
14x42	18	47.6	4.13	6.3	150	250
16x48	20	54.4	5.63	8	192	320
18x54	21	61.2	6.6	10	246	410
20x60	25	68	8.6	12.5	300	500
22x66	28	74.8	10.2	15.3	366	610

### CALIBRATED LOAD CHAIN FOR HOISTS(GRADE 100) STANDARD EN818-7

Size dxp (mm)	Width		Approx Weight (kg/m)	Working Load Limit (t)	Test Load (KN)	Breaking Load min.KN
	Inside min.w1	Outside max.w3				
3x9	3.8	10.2	0.21	0.36	8.8	14.1
4x12	5	13.6	0.35	0.63	15.7	25.1
5x15	6.3	17	0.54	1	24.5	39.3
6x18	7.5	20.4	0.79	1.44	35.3	56.6
6.3x19	7.9	20.4	0.86	1.6	39	62.3
7x21	9	23.8	1.07	2	49.5	79.2
8x24	10	27.2	1.38	2.5	62.8	101
9x27	11.3	30.6	1.76	3.15	79.5	127
10x30	12.5	34	2.2	4	98.2	157
11.2x34	14	37.4	2.71	4.8	118.5	185

## CALIBRATED RIGGING CHAIN ★

### CALIBRATED CHAIN(GRADE 80) STANDARD EN818-2

According to the user needs to provide hot-dip zinc, dacromet, metal coated, black, oil and various, surface treatments on the chain.

Safety Assurance: 4-fold safety factor of 2.5 times the proof load.

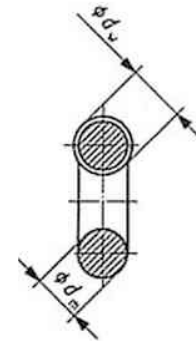
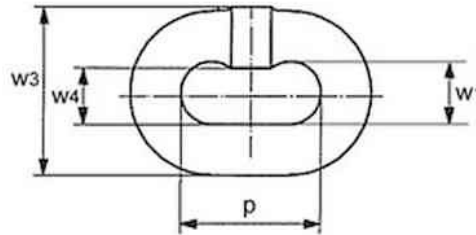

Size dxp (mm)	Width		Approx Weight (kg/m)	Working Load Limit (t)	Test Load (KN)	Breaking Load min.KN
	Inside min.w1	Outside max.w3				
4x12	5.2	14.8	0.35	0.5	12.6	20.1
5x15	6.5	18.5	0.5	0.8	19.6	31.4
6x18	7.8	22.2	0.8	1.12	28.3	45.2
7x21	9.1	25.9	1.1	1.5	38.5	61.6
8x24	10.4	29.6	1.4	2	50.3	80.4
10x30	13	37	2.2	3.15	78.5	126
13x39	16.9	48.1	3.8	5.3	133	212
16x48	20.8	59.2	5.7	8	201	322
18x54	23.4	66.6	7.3	10	254	407
19x57	24.7	70.3	8.1	11.2	284	454
20x60	26	74	9	12.5	314	503
22x66	28.6	81.4	10.9	15	380	608
23x69	29.9	85.1	12	16	415	665
25x75	32.5	92.5	14.1	20	491	785
26x78	33.8	96.2	15.2	21.2	531	849
28x84	36.4	104	17.6	25	616	985
32x96	41.6	118	23	31.5	804	1290
36x108	46.8	133	29	40	1020	1630
40x120	52	148	36	50	1260	2010
45x135	58.5	167	45.5	63	1590	2540

## MANUAL TROLLEY ★

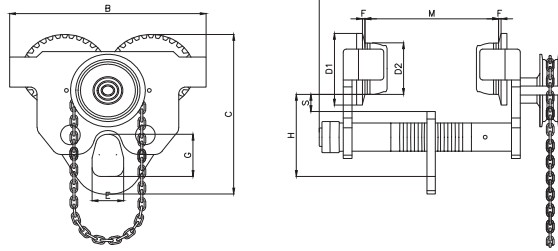

## EPTDG TYPE GEARED TROLLEY ★

Model	Rated capacity (t)	Min. Curve Radlue (m)	Beam Flange Width(mm)	Dimensions(mm)										Net Weight(kg)
				M	A	B	C	D1	D2	F	E	G	H	
EPTDG 0.5	0.5	0.8	68-126	250	196	174	Φ78	Φ57	1.5-3	24	38	97	22	8.2
EPTDG 1	1.0	0.9	80-146	260	213	174	Φ84	Φ60	1.5-3	24	38	89	27	10.8
EPTDG 2	2.0	1.0	80-150	299	255	216	Φ102	Φ75	1.5-3	37	52	111	33	16.6
EPTDG 3	3.0	1.2	80-150	312	300	249	Φ120	Φ90	1.5-3	42	59	117	30	24.5
EPTDG 5	5.0	1.3	100-203	378	340	305	Φ141	Φ110	1.5-3	46	75	154	43	39.6
EPTDG 10	10.0	1.6	122-203	418	450	410	Φ189	Φ150	1.5-3	72	110	195	45	81

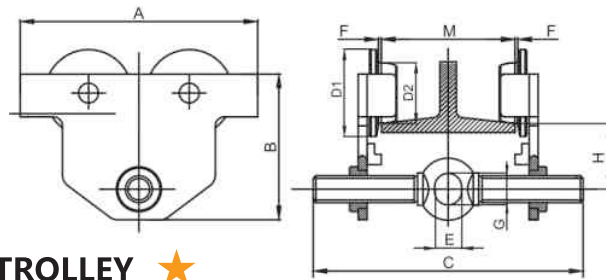

## EPAP TYPE PLAIN TROLLEY ★

Model	Rated capacity (t)	Min. Curve Radlue (m)	Beam Flange Width(mm)	Dimensions(mm)									Net Weight(kg)
				M	A	B	C	D1	D2	F	E	G	
EPTDG 0.5	0.5	0.8	64-220	200	150	292	Φ78	Φ57	1.5-3	25	30	65	5.9
EPTDG 1	1.0	0.9	64-220	240	163	300	Φ96	Φ67	1.5-3	30	35	75	9.3
EPTDG 2	2.0	1.0	88-220	286	190	310	Φ109.6	Φ80	1.5-3	40	47	80	15.3
EPTDG 3	3.0	1.2	102-220	320	225	320	Φ129.3	Φ92	1.5-3	48	58	95	24.7
EPTDG 5	5.0	1.3	114-220	370	255	335	Φ143	Φ109	1.5-3	60	75	105	39

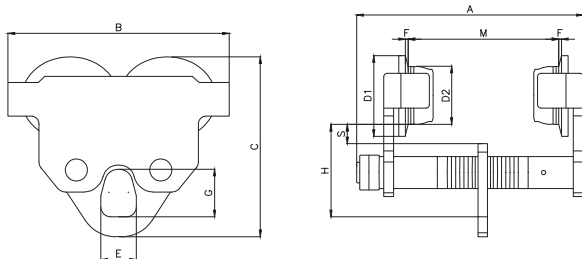

## EPTDP TYPE PLAIN TROLLEY ★

Model	Rated capacity (t)	Min. Curve Radlue (m)	Beam Flange Width(mm)	Dimensions(mm)										Net Weight(kg)
				M	A	B	C	D1	D2	F	E	G	H	
EPTDP 0.5	0.5	0.8	68-126	210	196	174	Φ78	Φ57	1.5-3	24	38	97	22	5.5
EPTDP 1	1.0	0.9	80-146	230	213	174	Φ84	Φ60	1.5-3	24	38	89	27	7.6
EPTDP 2	2.0	1.0	80-150	234	255	216	Φ102	Φ75	1.5-3	37	52	111	33	10
EPTDP 3	3.0	1.2	80-150	248	300	249	Φ120	Φ90	1.5-3	42	59	117	30	21
EPTDP 5	5.0	1.3	100-203	314	340	305	Φ141	Φ110	1.5-3	46	75	154	43	36.2
EPTDP 10	10.0	1.6	122-203	344	450	410	Φ189	Φ150	1.5-3	72	110	195	45	77.6

# FLAT WEBBING SLING

## 100% POLYESTER WEBBING SLINGS



All of our slings are made of A-A Grade polyester yarn.

All of them are specially PU coated, which makes them tighter, more durable & smooth.

**Standard:** According to EN1492-1+A1: 2008

**Standard:** According to ASME B30.9

**CE & G.S. certified**

**Double ply with reinforced lifting eyes.**

**Working Load:** 5000 kg

**Color:** Red

**Width:** 125mm/150mm

**Length Available:** 1m to 100m

**Elongation with working load:** 2-3%.

**Length tolerance:** Nominal length  $\pm 3\%$ .





**Material:** 100% high tenacity industry polyester yarn. Resistant to most acids but not to strong alkalis.

**Marking:** The slings are provided with a blue label with manufacturer's symbol, working load limit (WLL), length, CE marking and a label with handling instructions.

**Temperature range:** Approx.  $-40^{\circ}\text{C}$  -  $+100^{\circ}\text{C}$ .

**Standard:** EN 1492-1

**Safety factor:** 7:1.

Colour	WLL(t)	Width(mm)		Vertical Lifting(kg)	Choked Lifting(kg)	Basket Lifting(kg)		
		6:1	7:1	 x1	 x0.8	 x2	 7<B<45 x1.4	 45<B<60 x1
VIOLET	1	1"/25mm	30	1000	800	2000	1400	1000
GREEN	2	2"/50 mm	60	2000	1600	4000	2800	2000
YELLOW	3	3"/75 mm	90	3000	2400	6000	4200	3000
GREY	4	4"/100 mm	120	4000	3200	8000	5600	4000
RED	5	5"/125 mm	150	5000	4000	10000	7000	5000
BROWN	6	6"/150 mm	180	6000	4800	12000	8400	6000
BLUE	8	8"/200 mm	240	8000	6400	16000	11200	8000
ORANGE	10	10"/250 mm	300	10000	8000	20000	14000	10000
ORANGE	12	12"/300 mm	300	12000	9600	24000	16800	12000

## FLAT WEBBING SLING



### Item No.: EPFWS75

#### 5T POLYESTER FLAT WEBBING SLING

- Material:100% High tenacity industrial polyester yarn
- Color:Red
- Working Load:5000 kg
- Ply: Double
- With reinforced lifting eyes
- Length Available:1m to 12m
- Low elongation
- According to EN1492-1+A1:2008
- CE & G.S. certified

Safety Factor:7:1

Width:150mm

Safety Factor:7:1

Width:30mm

### Item No.: EPFWS71

#### 1T POLYESTER FLAT WEBBING SLING

- Material:100% High tenacity industrial polyester yarn
- Color:Violet
- Working Load:1000 kg
- Ply: Double
- With reinforced lifting eyes
- Length Available:1m to 12m
- Low elongation
- According to EN1492-1+A1:2008
- CE & G.S. certified



### Item No.: EPFWS74

#### 4T POLYESTER FLAT WEBBING SLING

- Material:100% High tenacity industrial polyester yarn
- Color:Grey
- Working Load:4000 kg
- Ply: Double
- With reinforced lifting eyes
- Length Available:1m to 12m
- Low elongation
- According to EN1492-1+A1:2008
- CE & G.S. certified



Safety Factor:7:1

Width:120mm

Safety Factor:7:1

Width:60mm

### Item No.: EPFWS72

#### 2T POLYESTER FLAT WEBBING SLING

- Material:100% High tenacity industrial polyester yarn
- Color:Green
- Working Load:2000 kg
- Ply: Double
- With reinforced lifting eyes
- Length Available:1m to 12m
- Low elongation
- According to EN1492-1+A1:2008
- CE & G.S. certified

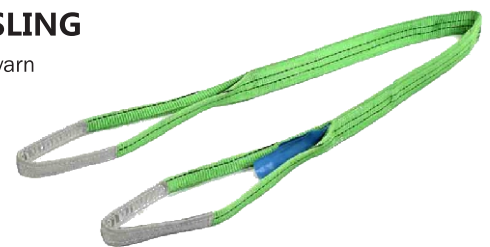

### Item No.: EPFWS73

#### 3T POLYESTER FLAT WEBBING SLING

- Material:100% High tenacity industrial polyester yarn
- Color:Yellow
- Working Load:3000 kg
- Ply: Double
- With reinforced lifting eyes
- Length Available:1m to 12m
- Low elongation
- According to EN1492-1+A1:2008
- CE & G.S. certified



Safety Factor:7:1

Width:90mm

## FLAT WEBBING SLING

### Item No.: EPFWS76

#### 6T POLYESTER FLAT WEBBING SLING

- Material:100% High tenacity industrial polyester yarn
- Color:Brown
- Working Load:6000 kg
- Ply: Double
- With reinforced lifting eyes
- Length Available:1m to 12m
- Low elongation
- According to EN1492-1+A1:2008
- CE & G.S. certified



Safety Factor:7:1

Width:180mm

### Item No.: EPFWS78

#### 8T POLYESTER FLAT WEBBING SLING

- Material:100% High tenacity industrial polyester yarn
- Color:Blue
- Working Load:8000 kg
- Ply: Double
- With reinforced lifting eyes
- Length Available:1m to 12m
- Low elongation
- According to EN1492-1+A1:2008
- CE & G.S. certified

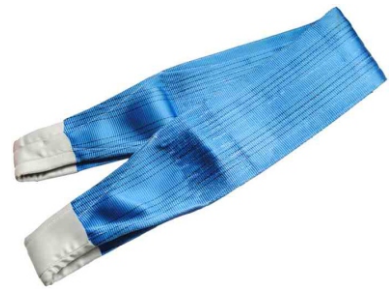

Safety Factor:7:1

Width:240mm

### Item No.: EPFWS710

#### 10T POLYESTER FLAT WEBBING SLING

- Material:100% High tenacity industrial polyester yarn
- Color:Orange
- Working Load:10000 kg
- Ply: Double
- With reinforced lifting eyes
- Length Available:1m to 12m
- Low elongation
- According to EN1492-1+A1:2008
- CE & G.S. certified



Safety Factor:7:1

Width:300mm

### Item No.: EPFWS712

#### 12T POLYESTER FLAT WEBBING SLING

- Material:100% High tenacity industrial polyester yarn
- Color:Orange
- Working Load:12000 kg
- Ply: Double
- With reinforced lifting eyes
- Length Available:1m to 12m
- Low elongation
- According to EN1492-1+A1:2008
- CE & G.S. certified



Safety Factor:7:1

Width:300mm



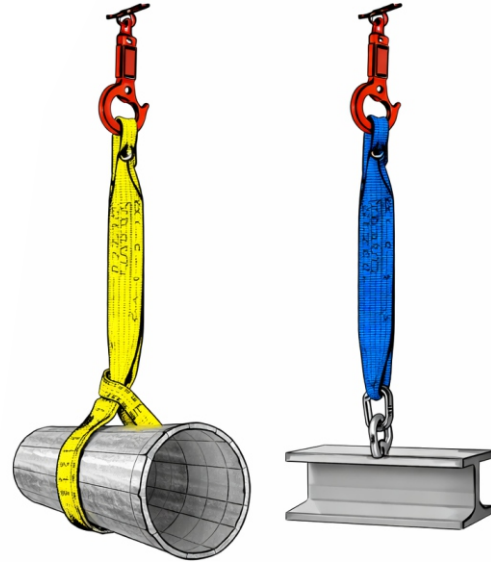

## FLAT POLYESTER WEBBING SLINGS

- » Europull manufactures a wide range of Flat Webbing Slings made with high tenacity polyester webbing.
- » Slings are manufactured either to EN 1492-1 with Safety Factor 7:1
- » We offer slings in MM system (i.e. 30mm, 60mm, 90mm etc.) and also in Inch system (i.e. 1", 2", 3" etc)







### Technical details

Capacity Chart in KGS for 1-PLY and 2-PLY Flat Polyester Webbing Slings

Colour Code	Width in Inches	M=1 		M=.8 		M=2 		0°-45° 		45°-60° 	
		Straight Lift - 100%		Choker Lift - 80%		Basket/U-Lift - 200%		At angle Beta - 140%		At angle Beta - 100%	
		1-PLY	2 -PLY	1-PLY	2 -PLY	1-PLY	2 -PLY	1-PLY	2 -PLY	1-PLY	2 -PLY
Violet	1	500	1000	400	800	1000	2000	700	1400	500	1000
Green	2	1000	2000	800	1600	2000	4000	1400	2800	1000	2000
Yellow	3	1500	3000	1200	2400	3000	6000	2100	4200	1500	3000
Grey	4	2000	4000	1600	3200	4000	8000	2800	5600	2000	4000
Red	5	2500	5000	2000	4000	5000	10000	3500	7000	2500	5000
Brown	6	3000	6000	2400	4800	6000	12000	4200	8400	3000	6000
Blue	8	4000	8000	3200	6400	8000	16000	5600	11200	4000	8000
Orange	10	5000	10000	4000	8000	10000	20000	7000	14000	5000	10000
Orange	12	6000	12000	4800	9600	12000	24000	8400	16800	6000	12000

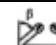
Capacity Chart in KGS for 3-PLY and 4-PLY Flat Polyester Webbing Slings

Colour Code	Width in Inches	M=1 		M=.8 		M=2 		0°-45° 		45°-60° 	
		Straight Lift - 100%		Choker Lift - 80%		Basket/U-Lift - 200%		At angle Beta - 140%		At angle Beta - 100%	
		3-PLY	4 -PLY	3-PLY	4 -PLY	3-PLY	4 -PLY	3-PLY	4 -PLY	3-PLY	4 -PLY
Violet	1	1500	2000	1200	1600	3000	4000	2100	2800	1500	2000
Green	2	3000	4000	2400	3200	6000	8000	4200	5600	3000	4000
Yellow	3	4500	6000	3600	4800	9000	12000	6300	8400	4500	6000
Grey	4	6000	8000	4800	6400	12000	16000	8400	11200	6000	8000
Red	5	7500	10000	6000	8000	15000	20000	10500	14000	7500	10000
Brown	6	9000	12000	7200	9600	18000	24000	12600	16800	9000	12000
Blue	8	12000	16000	9600	12800	24000	32000	16800	22400	12000	16000
Orange	10	15000	20000	12000	16000	30000	40000	21000	28000	15000	20000
Orange	12	18000	24000	14400	19200	36000	48000	25200	33600	18000	24000

# CARGO LASHING

Europull cargo lashing systems, made with high quality polyester yarn, are light weight and easy to use. The ratchet buckle and corresponding straps make an optimum combination to secure both light and heavy loads.



3 inch Cargo Lashing



2 inch Cargo Lashing



1 inch Cargo Lashing

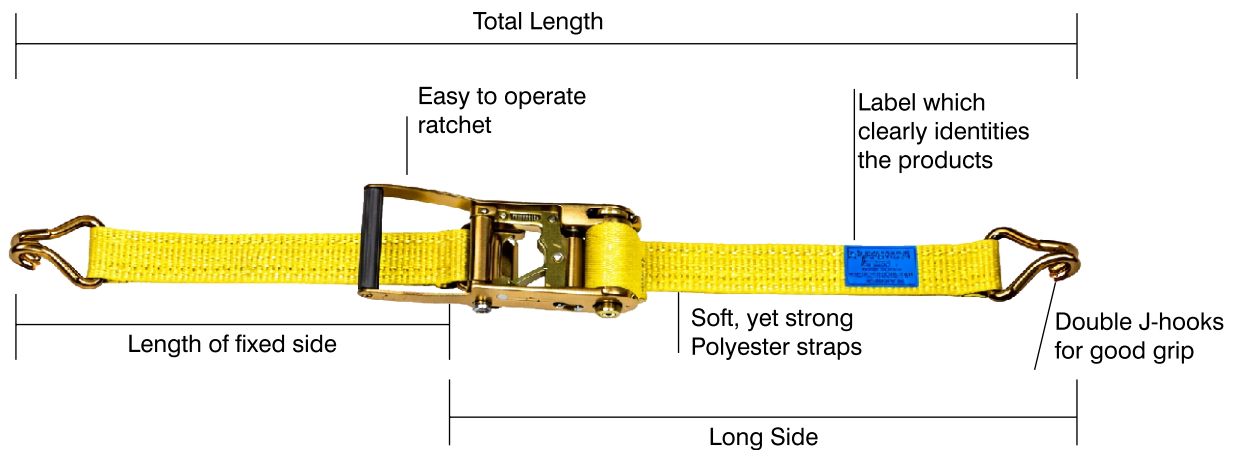

## Technical details

Webbing width	Minimum Breaking Strength	End- Fitting Type	Type
1"	1,000 Kgs	Double J Hook	Ratchet
2"	5,000 Kgs	Double J Hook	Ratchet
3"	10,000 Kgs	Double J Hook	Ratchet

# SAFETY HARNESS

## EP500+EP125 - SAFETY HARNESS

### EUROPULL - FULL BODY SAFETY HARNESS

EUROPULL EP500 full body safety harness enhances the level of safety to the maximum and provides comfort to the wearer working at heights.

#### Salient features:

- » Secure fit ensuring safety and comfort
- » Retro-reflective strip/strands and hi-visibility material for better visibility even in low illumination areas. 24/7
- » 7 point harness designed for increasing safety, comfort and suit different body contours.
- » A – Shape rear reinforcement for secure fit to avoid slippage.
- » Light weight high strength forged aluminium dorsal D – Ring.
- » Muddle free design

#### Description

7 Points Adjustment | Rear Anchorage Point (*forged dorsal ring with smooth finish*) | Adjustable Shoulder and Thigh Straps with flat buckles | Reflective Tape on shoulders | Reflector Webbing Yarn. | Webbing width – 45mm | Breaking strength 5000 lbs | High visibility color

Standard: EN361:2002, EN 355:2002, EN 354, and EN 362:2004

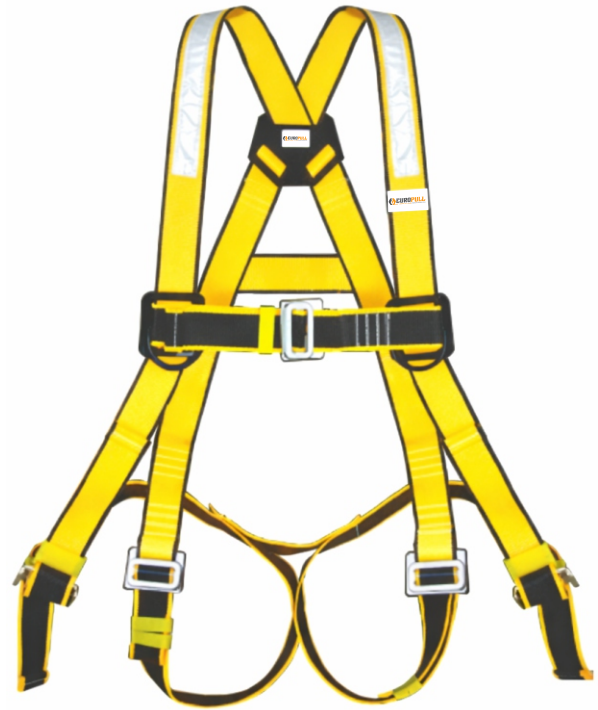

Rear Anchor Point fitted with aluminium ring



Adjustable Chest Webbing with tools holder



Reflective Tape on Shoulder for better visibility



Chrome Finish Steel Buckles for corrosion resistance



A shape Rear Webbing for avoiding slippage

## EP 125 (EP125+EP5104+EP5204)

EUROPULL Shock Absorber with double webbing lanyard with 2 Rebar hooks and 1 Snap Hook 25Kn.

#### Salient features:

Double webbing lanyard: retro-reflective thread across full body which makes it visibly discernible in dawn and dusky working conditions.

Shock absorber: EP125 shock absorber regulates deceleration when the end of rope is reached on free fall. (Refer to instruction manual)

Connectors: 2 units of Rebar, 1 unit of Snap Hook with 25KN rated capacity.

Length of lanyard: 2 Mtr. from one end connector eye to the other, width: 30mm

Material: 100% polyester webbing

#### Description

Shock Absorber lanyard 2 Mtr. | visibility color | Webbing width 30mm | Two Scaffolding hooks | One Snap Hook connector | 100% Polyester



Model	Product Description	Reference	
EP444+EP125	Double Webbing Lanyard With Shock Absorber, 2 Rebar Hook + 1 Karabiner With A Rated Capacity Of 25kn	Connector 1 2 EP51A04	Connector 2 1 EP5204
EP555+EP125	Double Webbing Lanyard With Shock Absorber, 2 Rebar + 1 Snap Hook, With A Rated Capacity Of 25kn	Connector 1 2 EP51A04	Connector 2 1 EP5204

Standard: EN361:2002, EN 355:2002, EN 354, and EN 362:2004



**RIGGING**



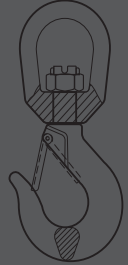
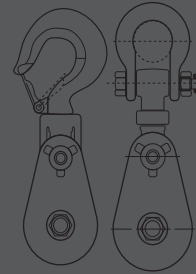
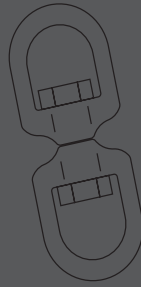
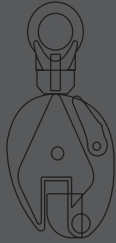

## Europull Hebentechnik UK Ltd

📍 61 Bridge Street, Kington.HR5 3DJ,  
United Kingdom.

✉ info@europull.com

[www.europull.com](http://www.europull.com)